



RPI RE-FLEX SYSTEMS

- EPDM MEMBRANE
- TPO MEMBRANE
- COATINGS



RPI ROYAL EDGE SYSTEMS

- EPDM MEMBRANE

RE-FLEX TPO HEAT WELD DETAILS FOR MECHANICALLY ATTACHED SYSTEM

DETAIL NUMBER	DESCRIPTION
HW 301	FIELD SHEET LAYOUT
HW 302	HEAT WELD SIDE LAP
HW 303	COVER STRIP END LAP
HW 304	END LAP
HW 305	T-JOINT COVER PATCH
HW 306	ROOF AREA ZONE LAYOUT
HW 307	RIDGE
HW 308	CHANGE OF PLANE
HW 309	VALLEY
HW 310	CUT EDGE SEALANT
HW 311	MEMBRANE EDGE GUIDE
HW 312	COATED METAL ROOF EDGE
HW 313	COATED METAL EDGE JOINT
HW 314	SNAP-ON FASCIA ROOF METAL EDGE
HW 315	ROOF EDGE WITH TPO COVER TAPE
HW 316	TPO COVER TAPE OVERLAP AT ROOF EDGE
HW 317	METAL DRIP EDGE CORNER CAULK
HW 318	WALL/CURB FLASHING WITH TERMINATION BAR
HW 319	NEW CONSTRUCTION WITH WALL CAP
HW 320	WALL FLASHING WITH COATED METAL EDGE
HW 321	ALTERNATE WALL BASE TERMINATION COATED METAL
HW 322	WALL FLASHING
HW 323	COATED METAL WALL SCUPPER
HW 324	VERTICAL OUTSIDE WALL EDGE TERMINATION WITH COATED METAL
HW 325	INSIDE CORNER PREFORMED FLASHING
HW 326	REINFORCED ANCHOR STRIP - INSIDE CORNER OUTSIDE
HW 327	CORNER PREFORMED FLASHING
HW 328	PRE-FABRICATED EXPANSION JOINT-FLAT TYPE
HW 329	PRE-FABRICATED EXPANSION JOINT-CURB TYPE FACTORY
HW 330	FABRICATED WALL EXPANSION JOINT-FLAT TYPE
HW 331	INSULATED CURB TERMINATION WITH WELDED LAP
HW 332	INSULATED CURB TERMINATION WITH COUNTER FLASHING
HW 333	WOOD CURB FLASHING
HW 334	PREMOLDED VENT BOOT FLASHING
HW 335	DRAIN-STANDARD ROOF DRAIN FLASHING
HW 336	POURABLE PITCH POCKET
HW 337	PITCH POCKET SPLICE FLASHING
HW 338	HEAT-WELDED WALKWAY INSTALLATION

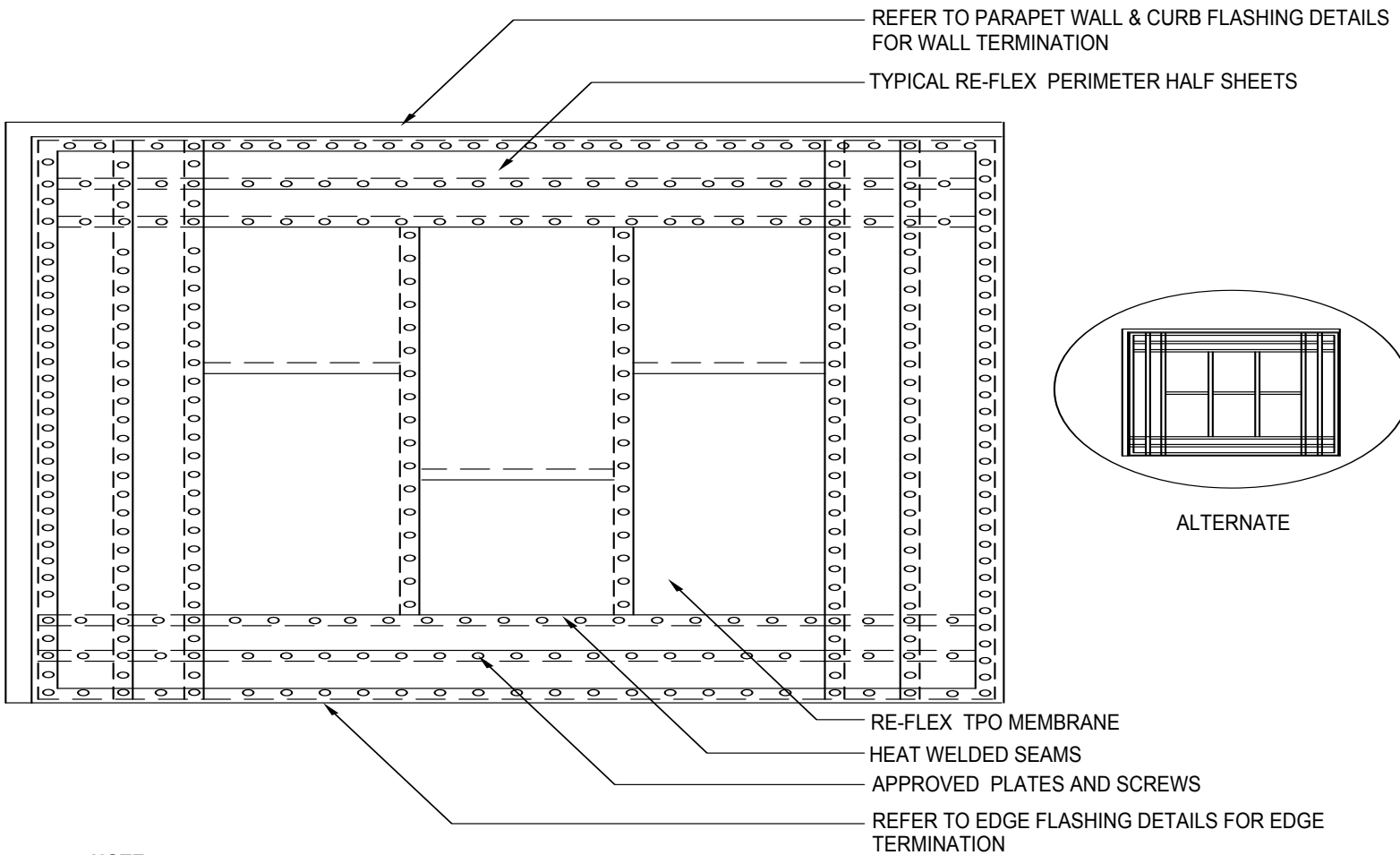

NOTE:

SEE RE-FLEX TPO MECHANICALLY ATTACHED SYSTEM SPECIFICATIONS TO DETERMINE FASTENER SPACING FOR VARIOUS DECK TYPES AND WIND UPLIFT REQUIREMENTS AND FOR REQUIRED NUMBER OF PERIMETER HALF SHEETS.

**FIELD SHEET LAYOUT
DETAIL**

ACCEPTABLE WITH RE-FLEX TPO MECHANICALLY ATTACHED SYSTEMS	
PROJECT:	SCALE
	NOT TO SCALE
Revision Date: 5-10-2015	#301



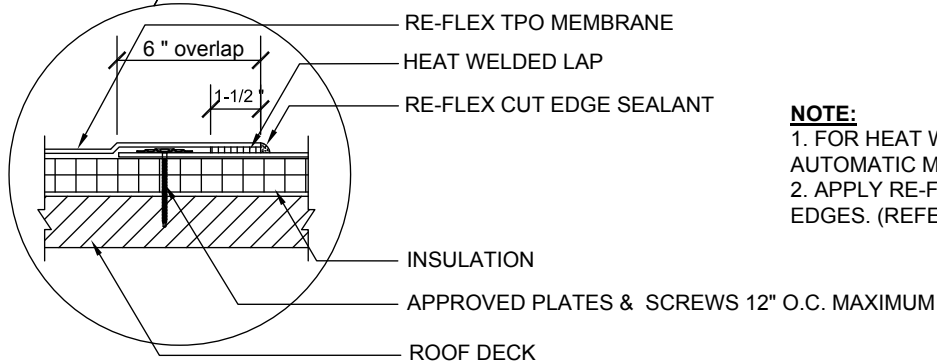
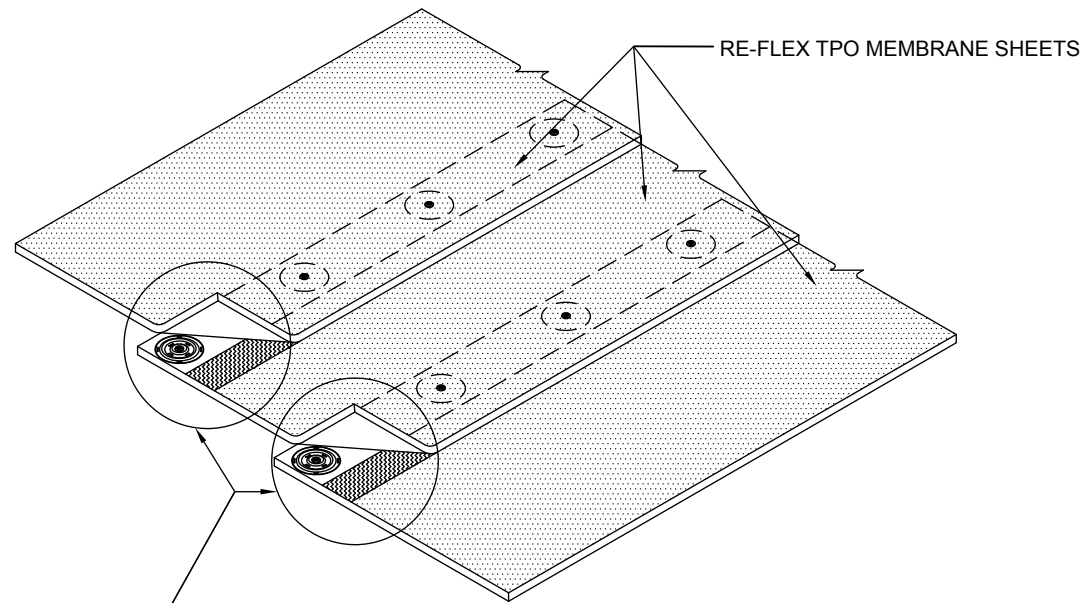

NOTE:

1. FOR HEAT WELDING LAPS USE 1 1/2" WELD WITH AUTOMATIC MACHINE WELDER.
2. APPLY RE-FLEX CUT EDGE SEALANT TO ALL FIELD CUT TPO EDGES. (REFER TO RE-FLEX TPO CUT EDGE SEALANT DETAIL)

RE-FLEX TPO HEAT WELD SIDE LAP DETAIL

ACCEPTABLE WITH RE-FLEX TPO MECHANICALLY ATTACHED SYSTEMS	
PROJECT:	SCALE
	NOT TO SCALE
Revision Date: 5-10-2015	#302



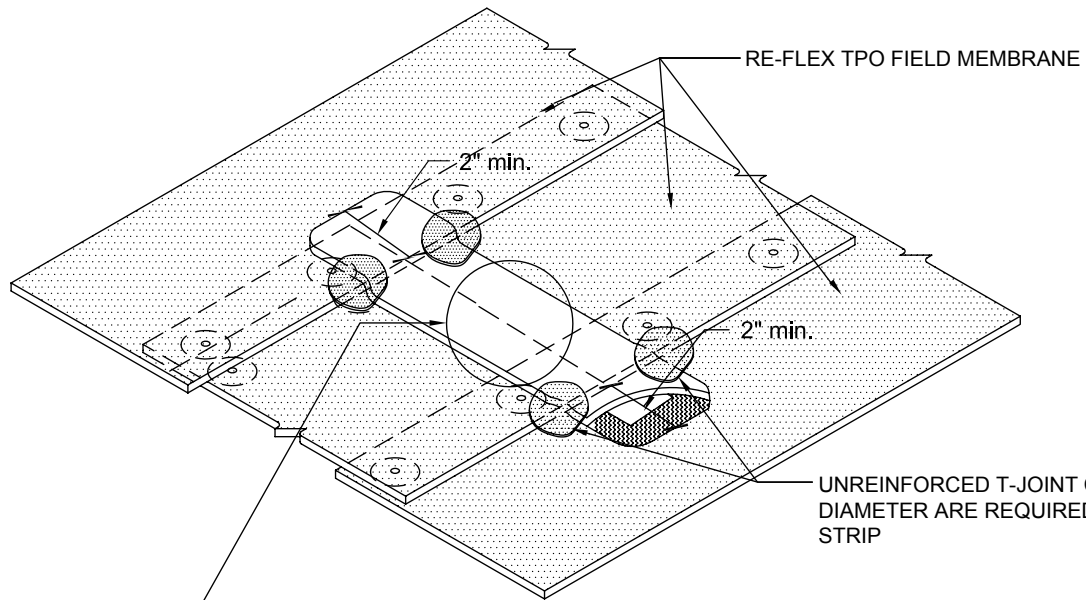

THIS DETAIL IS REQUIRED FOR ALL FLEECE-BACK MEMBRANE AND OPTIONAL FOR ALL SYSTEMS LISTED BELOW

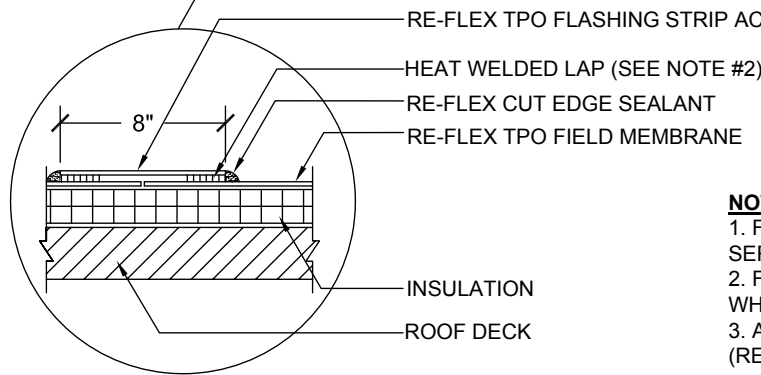

UNREINFORCED T-JOINT COVER PATCHES MIN. OF 4" IN DIAMETER ARE REQUIRED FOR 60/80 MIL FIELD FABRICATED STRIP

RE-FLEX TPO FLASHING STRIP ACCESSORY OR 8" WIDE REINFORCED RE-FLEX TPO MEMBRANE

HEAT WELDED LAP (SEE NOTE #2)

RE-FLEX CUT EDGE SEALANT

RE-FLEX TPO FIELD MEMBRANE

INSULATION

ROOF DECK

NOTE:

1. FOR INSULATION THICKNESS GREATER THAN 8", CONTACT RPI TECHNICAL SERVICES FOR ALTERNATE ATTACHMENT REQUIREMENTS.
2. FOR HEAT WELDING LAPS, USE 1 1/2" WELD WITH ROBOT WELDER AND 2" WHEN USING A HAND HELD WELDER.
3. APPLY RE-FLEX CUT EDGE SEALANT TO ALL FIELD CUT REINFORCED EDGES. (REFER TO CUT EDGE SEALANT DETAIL)

RE-FLEX TPO COVER STRIP HEAT WELD END LAP DETAIL

ACCEPTABLE WITH RE-FLEX TPO MECHANICALLY ATTACHED SYSTEMS	
PROJECT:	SCALE
	NOT TO SCALE
Revision Date: 5-10-2015	#303



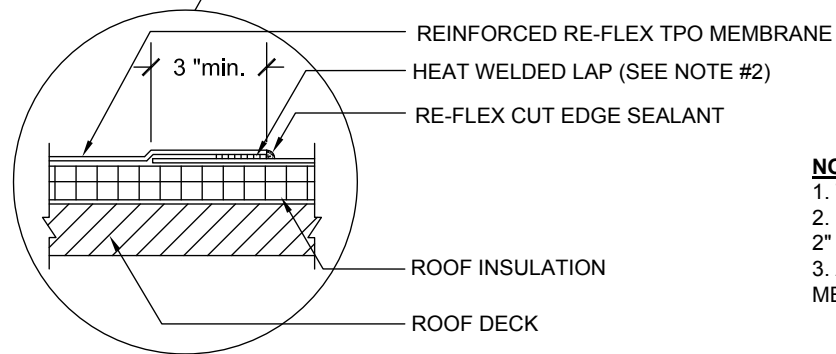
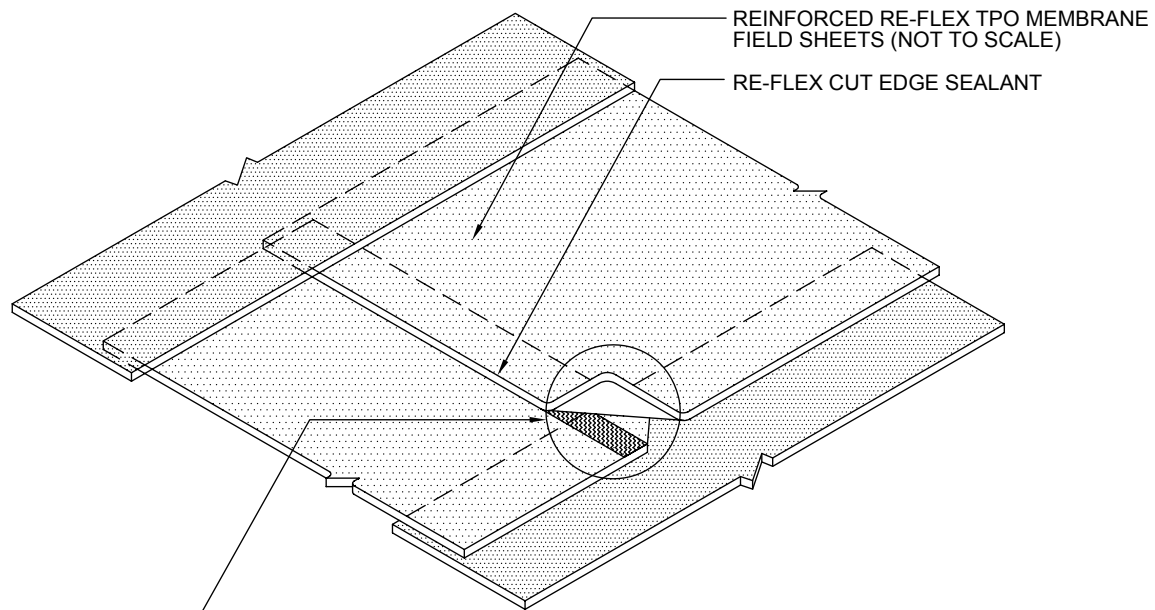

NOTE:

1. T-JOINT PATCH REQUIRED FOR .045/.060/.080 RE-FLEX TPO MEMBRANE.
2. HEAT WELD 1 1/2" LAP WHEN USING ROBOT (AUTOMATIC) WELDER AND 2" WELD WHEN HAND WELDING.
3. APPLY RE-FLEX CUT EDGE SEALANT TO ALL FIELD CUT REINFORCED MEMBRANE EDGES. (REFER TO RE-FLEX TPO CUT EDGE SEALANT DETAIL)

RE-FLEX TPO HEAT WELD END LAP DETAIL

ACCEPTABLE WITH RE-FLEX TPO
MECHANICALLY ATTACHED SYSTEMS

PROJECT:

SCALE

NOT TO SCALE

Revision Date: 5-10-2015

#304



Roofing Products International, Inc.

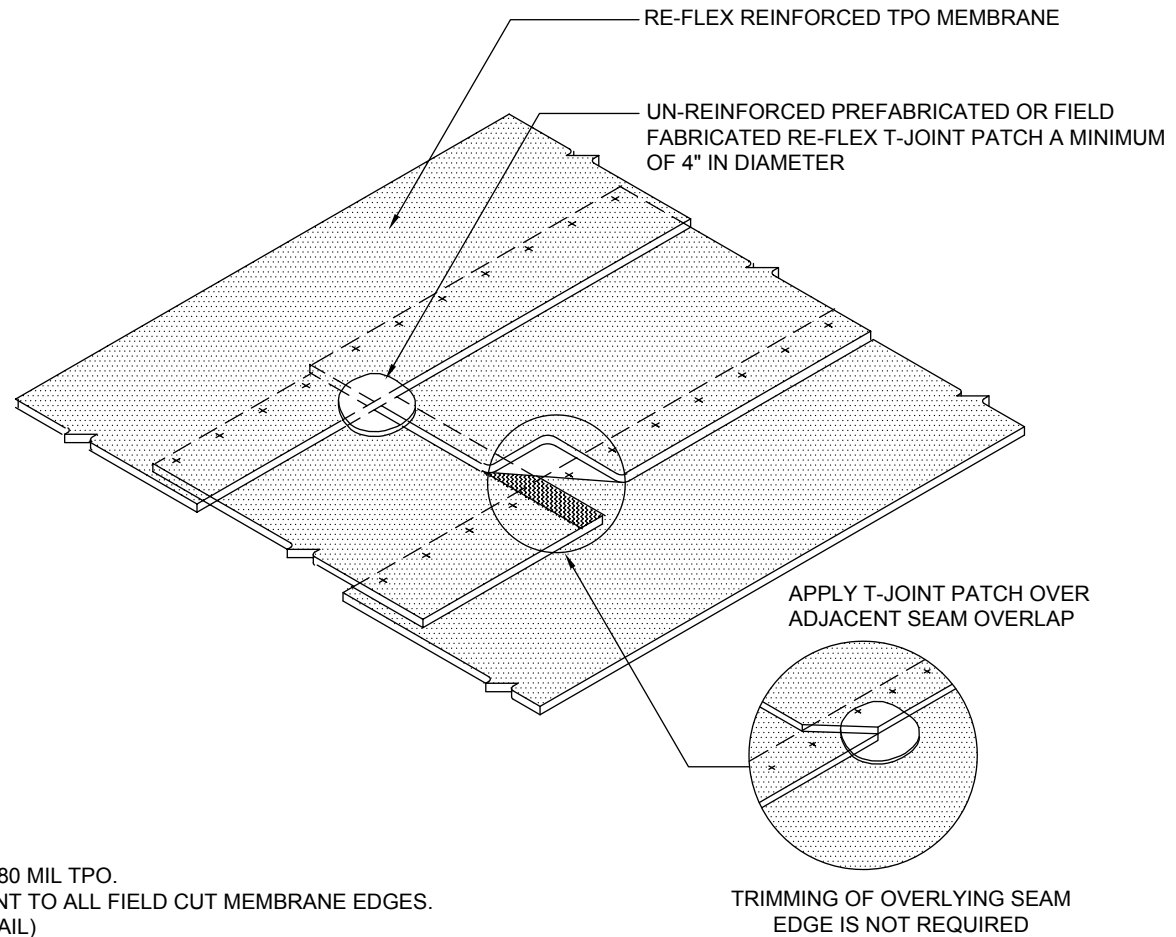

NOTE:

1. T-JOINT IS TO BE USED FOR .060/080 MIL TPO.
2. APPLY RE-FLEX CUT EDGE SEALANT TO ALL FIELD CUT MEMBRANE EDGES. (REFER TO CUT EDGE SEALANT DETAIL)

**RE-FLEX TPO T-JOINT
COVER PATCH HEAT WELD
DETAIL**

ACCEPTABLE WITH RE-FLEX TPO
MECHANICALLY ATTACHED SYSTEMS

PROJECT:

SCALE

NOT TO SCALE

Revision Date: 5-10-2015

#305



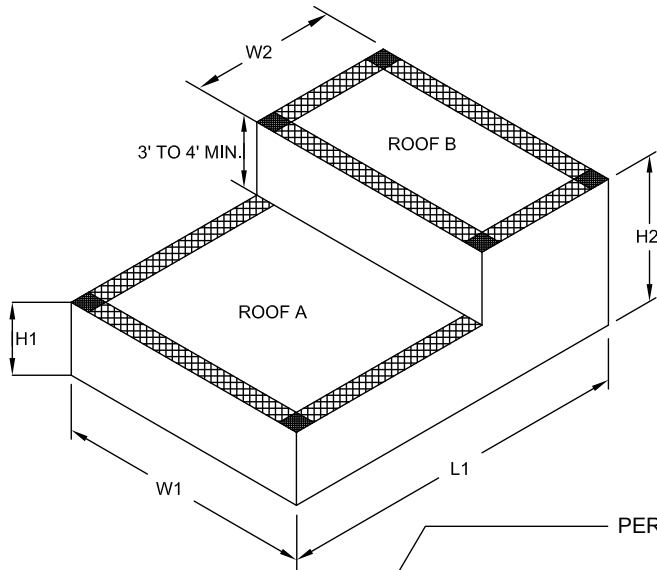

NOTE:

1. WIDTH OF THE PERIMETER TREATMENT (A OR B) SHALL BE 10% OF THE BUILDING'S NARROWEST WIDTH (W) OR 40% OF THE BUILDING EVE HEIGHT (H), WHICHEVER IS LESS WITH 4' BEING THE MINIMUM FOR WARRANTY REQUIREMENTS. SEE HALF SHEET REQUIREMENTS IN MECHANICALLY ATTACHED SECTION.
2. FOR ADHERED SYSTEMS, SEE INSULATION TABLE FOR ENHANCEMENTS.
3. FOR BALLAST SYSTEMS, REFER TO BALLAST SYSTEM APPLICATION TABLE.

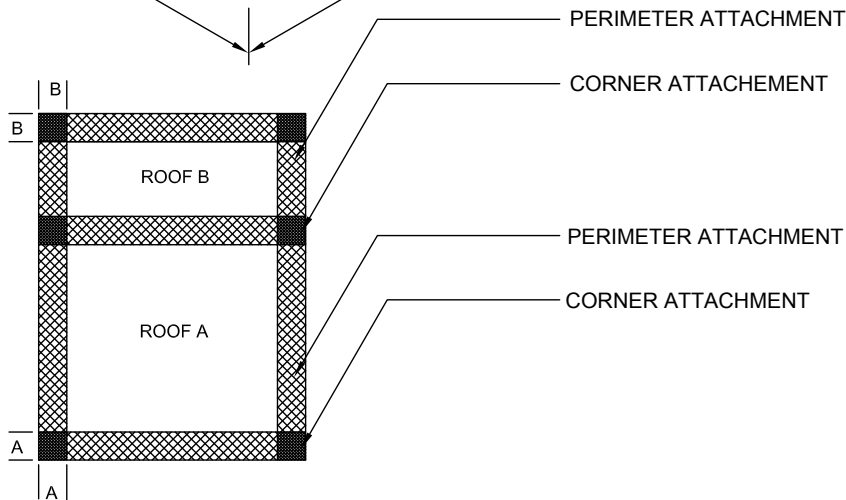

ROOF AREA ZONE LAYOUT DETAIL

ACCEPTABLE WITH RE-FLEX TPO MECHANICALLY ATTACHED SYSTEMS	
PROJECT:	SCALE
	NOT TO SCALE
Revision Date: 5-10-2015	#306



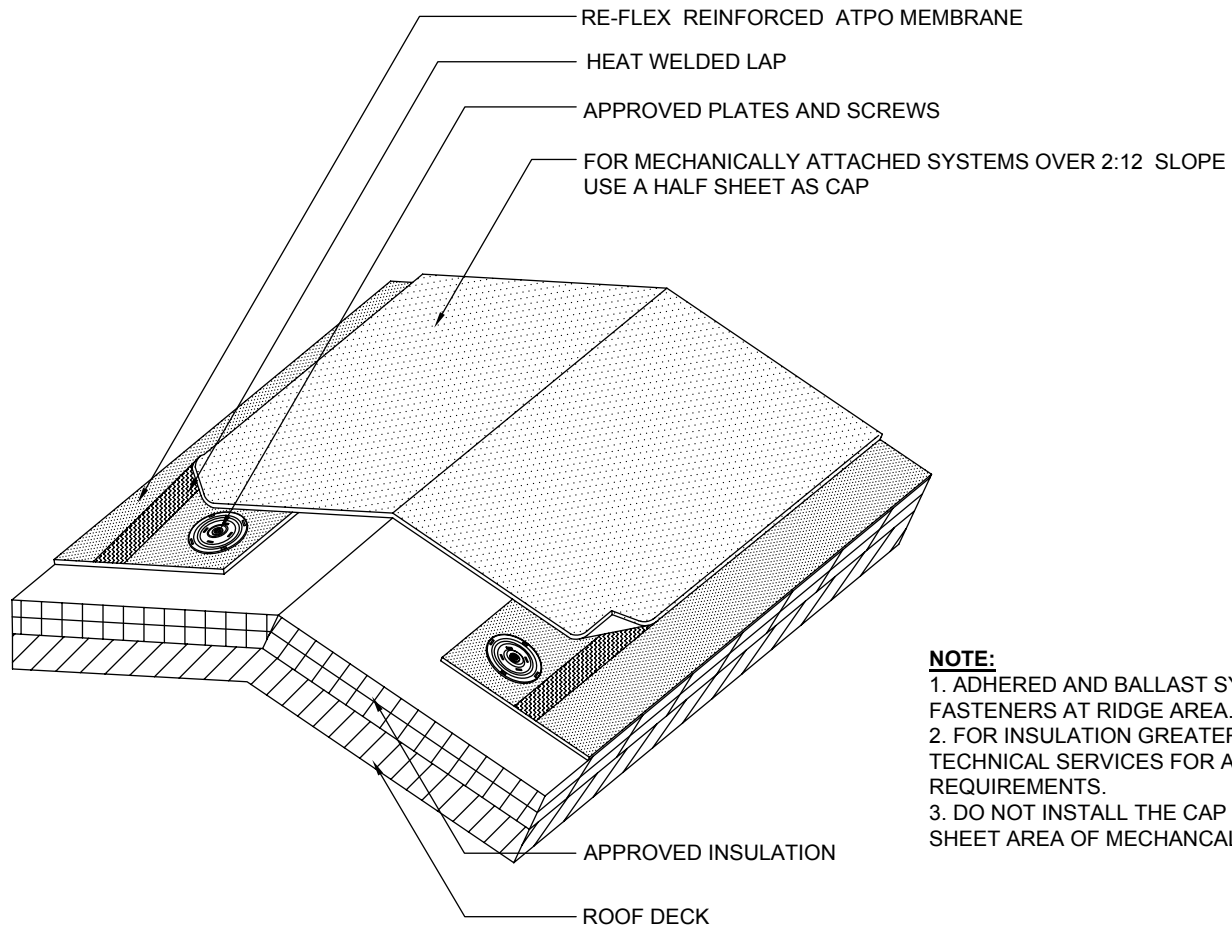

NOTE:

1. ADHERED AND BALLAST SYSTEMS DO NOT REQUIRE FASTENERS AT RIDGE AREA.
2. FOR INSULATION GREATER THAN 8", CONTACT RPI TECHNICAL SERVICES FOR ALTERNATE ATTACHMENT REQUIREMENTS.
3. DO NOT INSTALL THE CAP SHEET INTO THE PERIMETER HALF SHEET AREA OF MECHANICALLY ATTACHED SYSTEMS.

**RE-FLEX TPO RIDGE CAP
HEAT WELD DETAIL**

ACCEPTABLE WITH RE-FLEX TPO
MECHANICALLY ATTACHED SYSTEMS

PROJECT:

SCALE

NOT TO SCALE

Revision Date: 5-10-2015

#307



Roofing Products International, Inc.

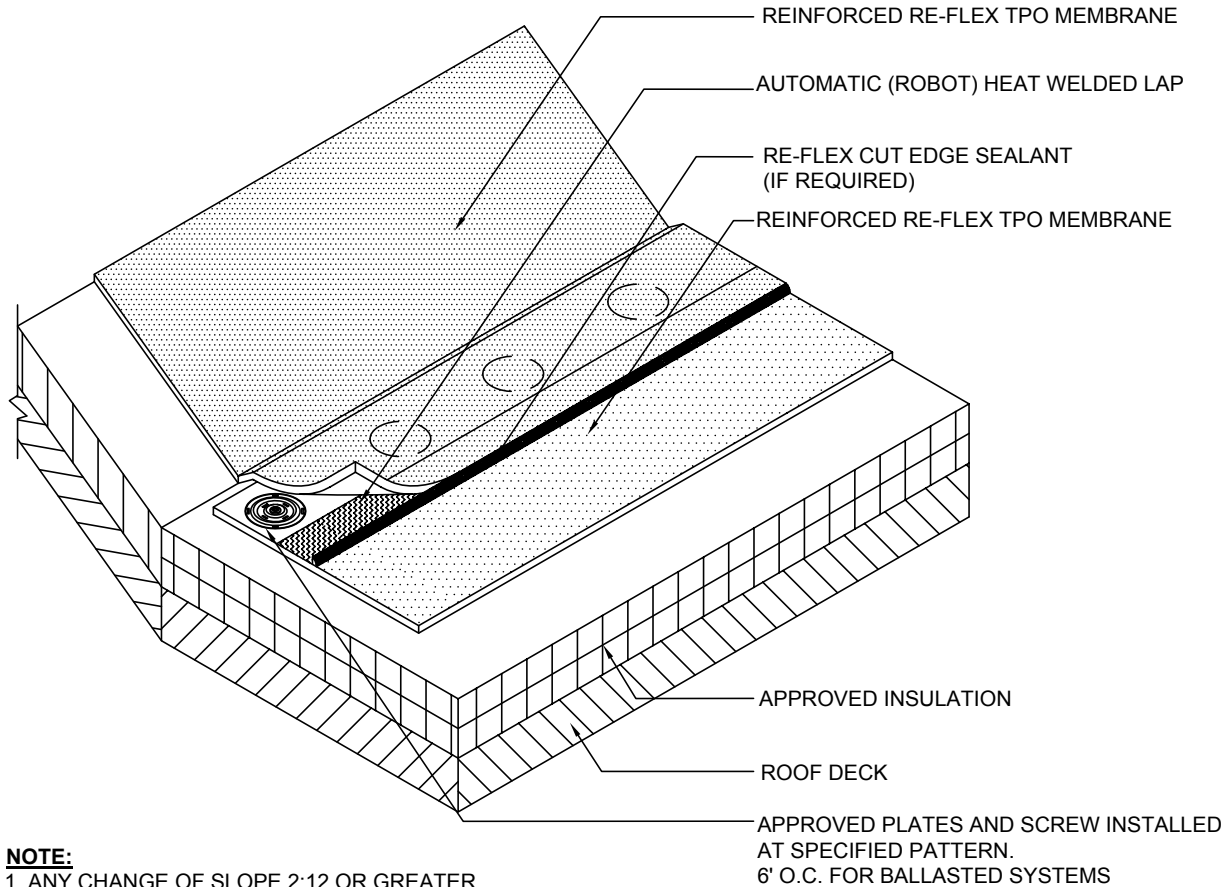

NOTE:
 1. ANY CHANGE OF SLOPE 2:12 OR GREATER
 MUST BE MECHANICALLY ATTACHED AT ANGLE CHANGE.
 2. APPLY RE-FLEX CUT EDGE SEALANT TO ALL FIELD CUT
 REINFORCED TPO EDGES.
 (REFER TO CUT EDGE SEALANT DETAIL)

RE-FLEX TPO CHANGE OF PLANE DETAIL

ACCEPTABLE WITH RE-FLEX TPO
 MECHANICALLY ATTACHED SYSTEMS

PROJECT:

SCALE

NOT TO SCALE

Revision Date: 5-10-2015

#308



Roofing Products International, Inc.

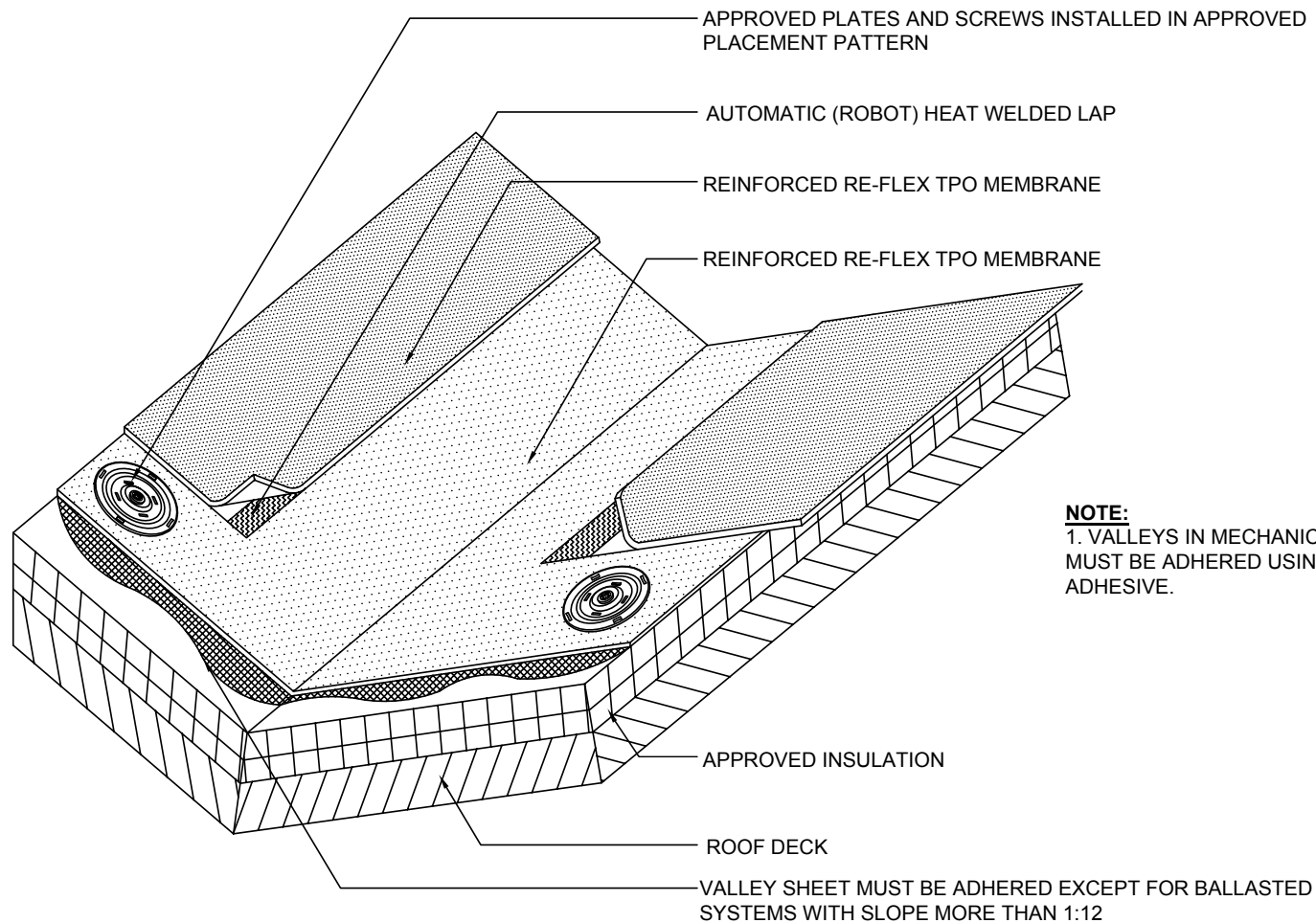

RE-FLEX TPO VALLEY DETAIL

ACCEPTABLE WITH RE-FLEX TPO MECHANICALLY ATTACHED SYSTEMS	
PROJECT:	SCALE
	NOT TO SCALE
Revision Date: 5-10-2015	#309



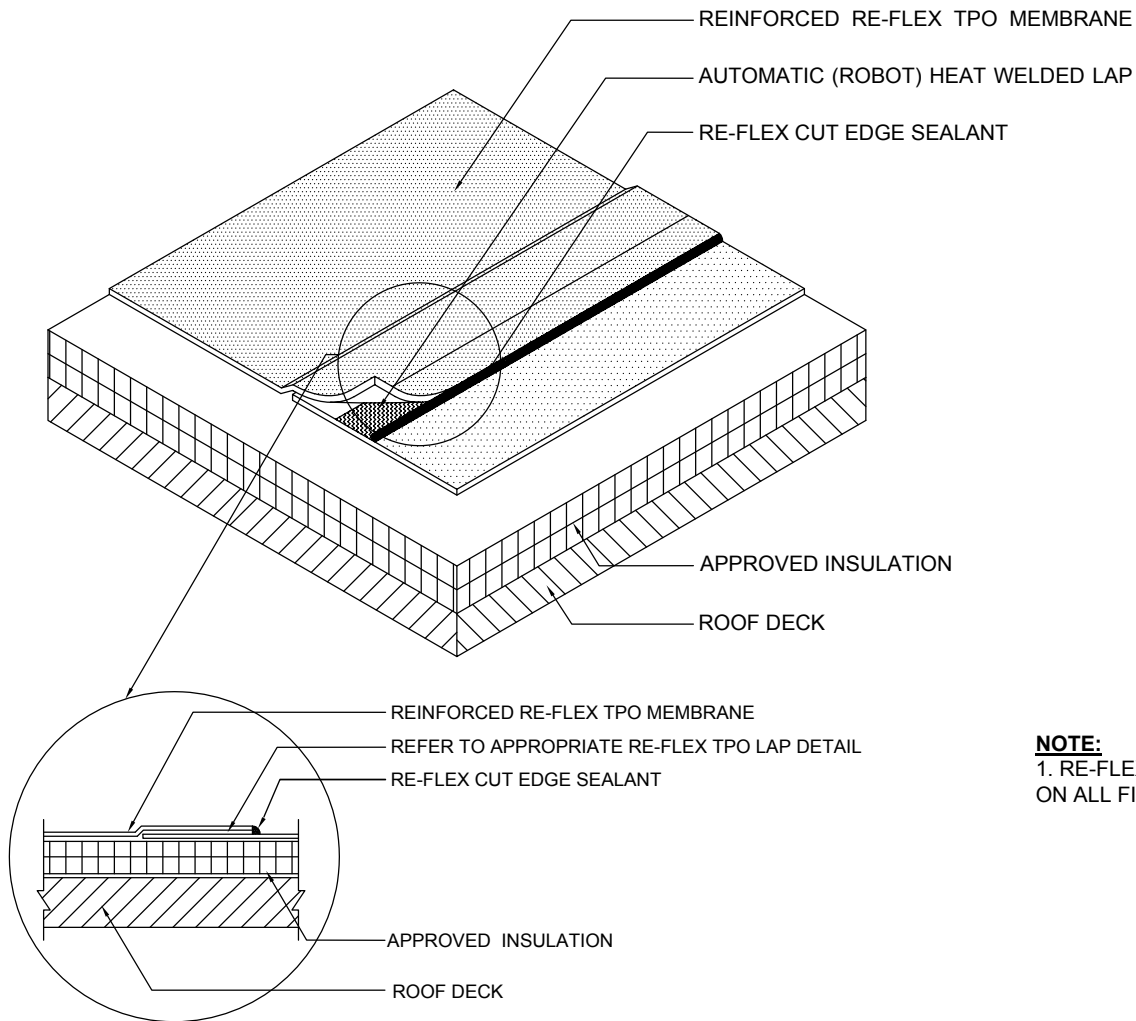

NOTE:
 1. RE-FLEX CUT EDGE SEALANT MUST BE USED ON ALL FIELD CUT MEMBRANE EDGES.

RE-FLEX CUT EDGE SEALANT DETAIL

ACCEPTABLE WITH RE-FLEX TPO
 MECHANICALLY ATTACHED SYSTEMS

PROJECT:

SCALE

NOT TO SCALE

Revision Date: 5-10-2015

#310



Roofing Products International, Inc.

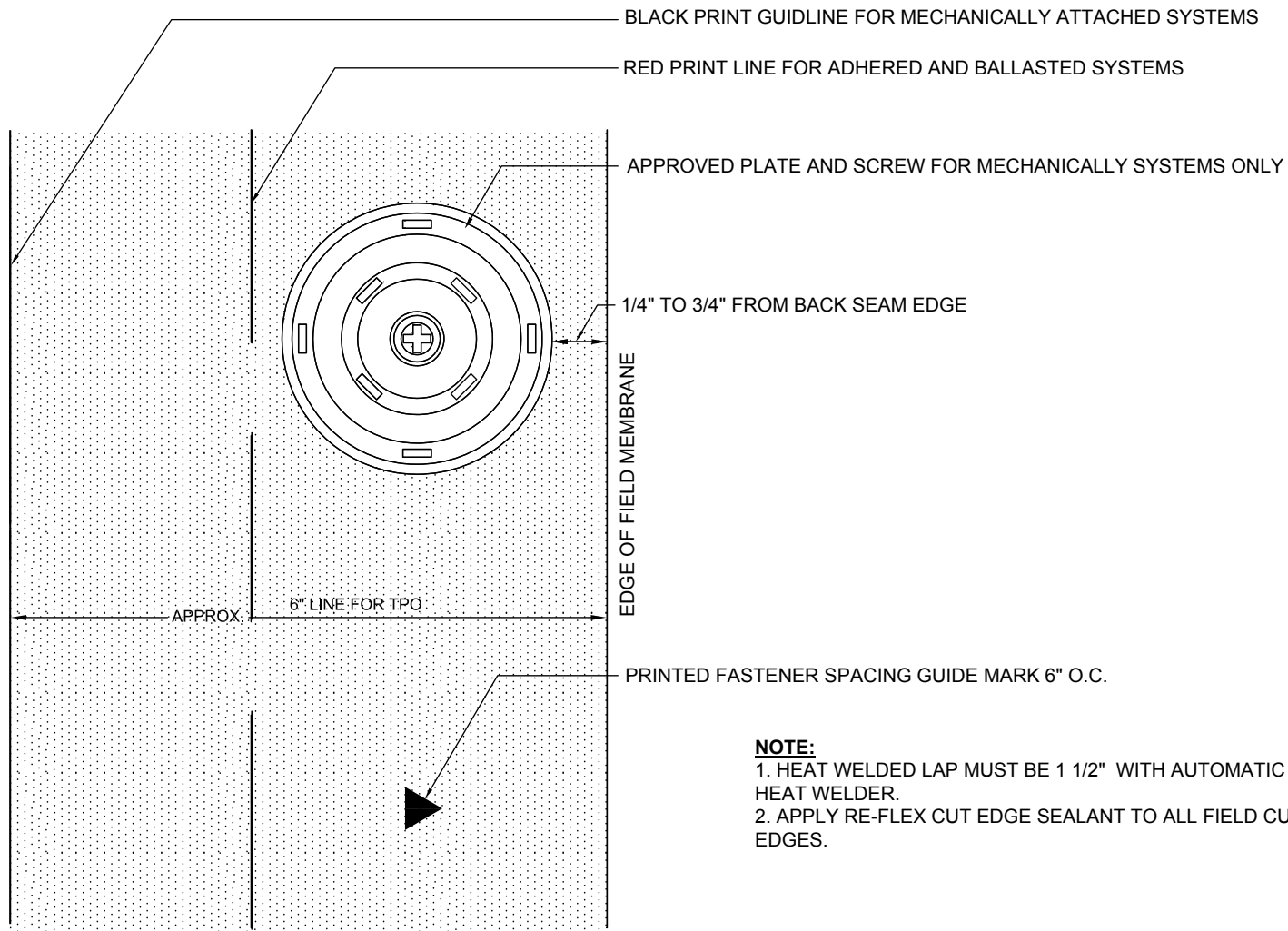

- NOTE:**
1. HEAT WELDED LAP MUST BE 1 1/2" WITH AUTOMATIC (ROBOT) HEAT WELDER.
 2. APPLY RE-FLEX CUT EDGE SEALANT TO ALL FIELD CUT SEAM EDGES.

RE-FLEX TPO MEMBRANE EDGE GUIDE DETAIL

ACCEPTABLE WITH RE-FLEX TPO MECHANICALLY ATTACHED SYSTEMS	
PROJECT:	SCALE
	NOT TO SCALE
Revision Date: 5-10-2015	#311



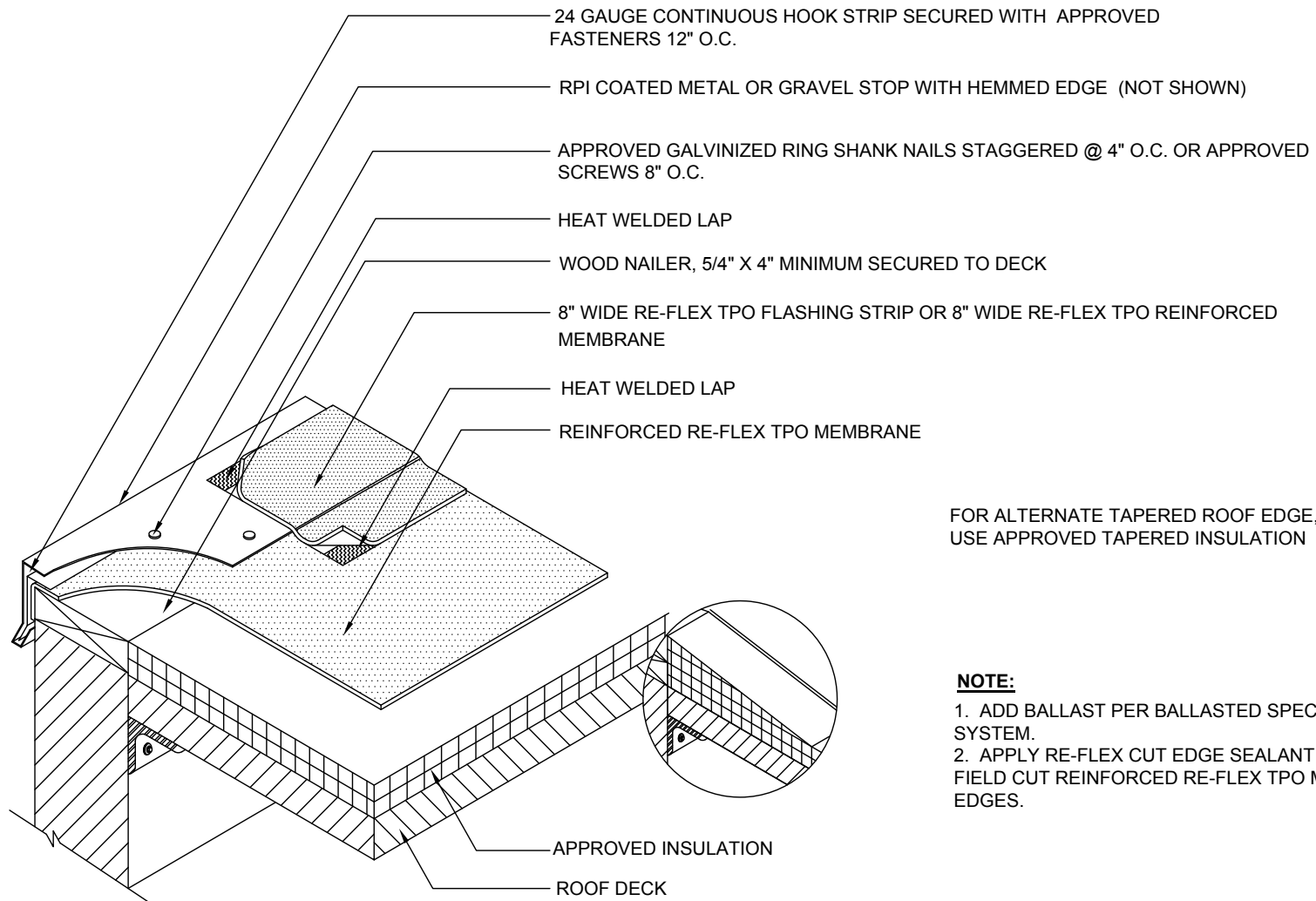

FOR ALTERNATE TAPERED ROOF EDGE,
USE APPROVED TAPERED INSULATION

NOTE:

1. ADD BALLAST PER BALLASTED SPECIFICATION SYSTEM.
2. APPLY RE-FLEX CUT EDGE SEALANT TO ALL FIELD CUT REINFORCED RE-FLEX TPO MEMBRANE EDGES.

RE-FLEX COATED METAL EDGE DETAIL

ACCEPTABLE WITH RE-FLEX TPO
MECHANICALLY ATTACHED SYSTEMS

PROJECT:

SCALE

NOT TO SCALE

Revision Date: 5-10-2015

#312



Roofing Products International, Inc.

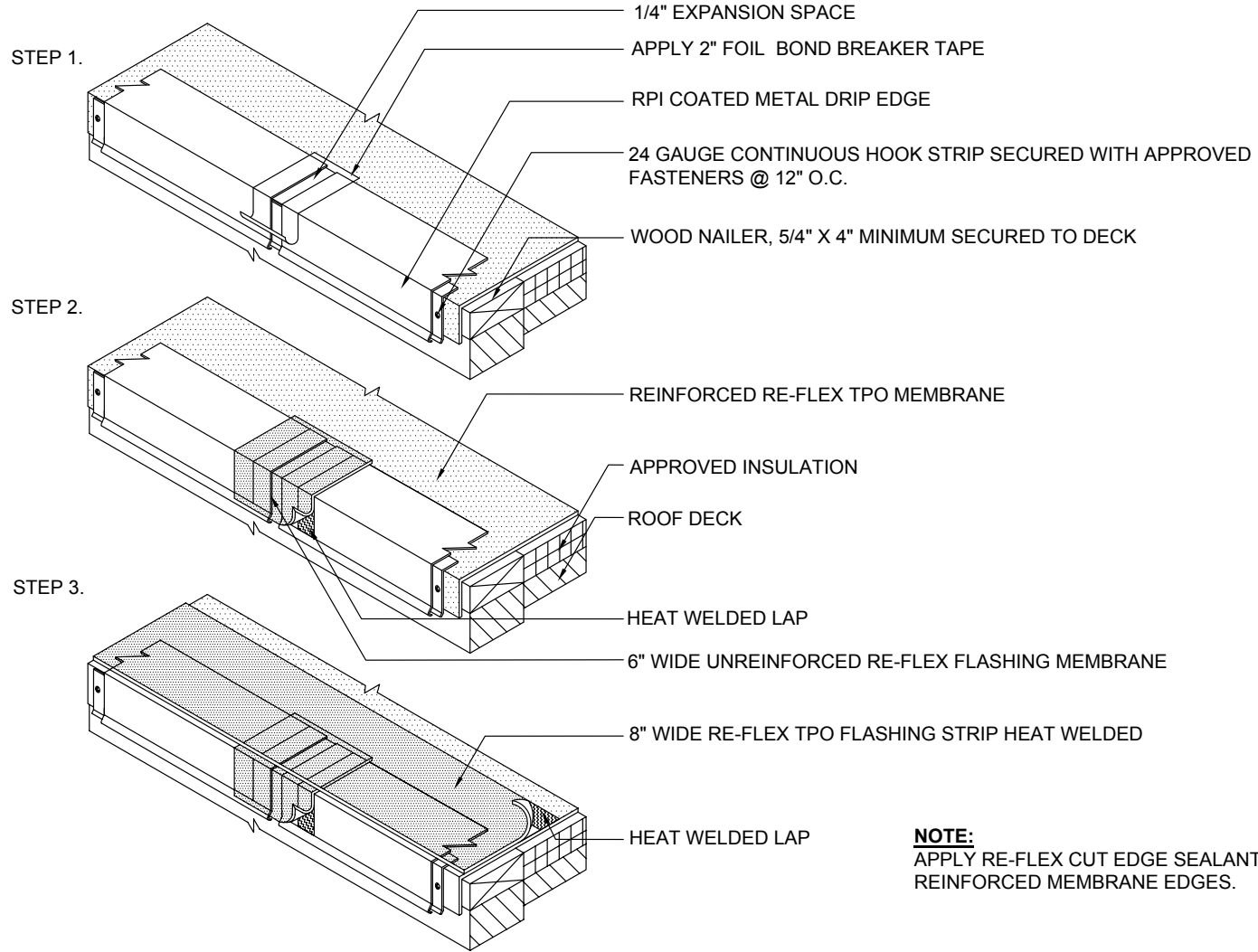

NOTE:
 APPLY RE-FLEX CUT EDGE SEALANT TO ALL FIELD CUT REINFORCED MEMBRANE EDGES.

RE-FLEX COATED METAL EDGE JOINT DETAIL

ACCEPTABLE WITH RE-FLEX TPO MECHANICALLY ATTACHED SYSTEMS	
PROJECT:	SCALE
	NOT TO SCALE
Revision Date: 5-10-2015	#313



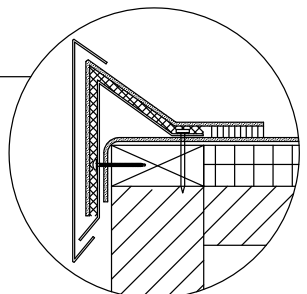
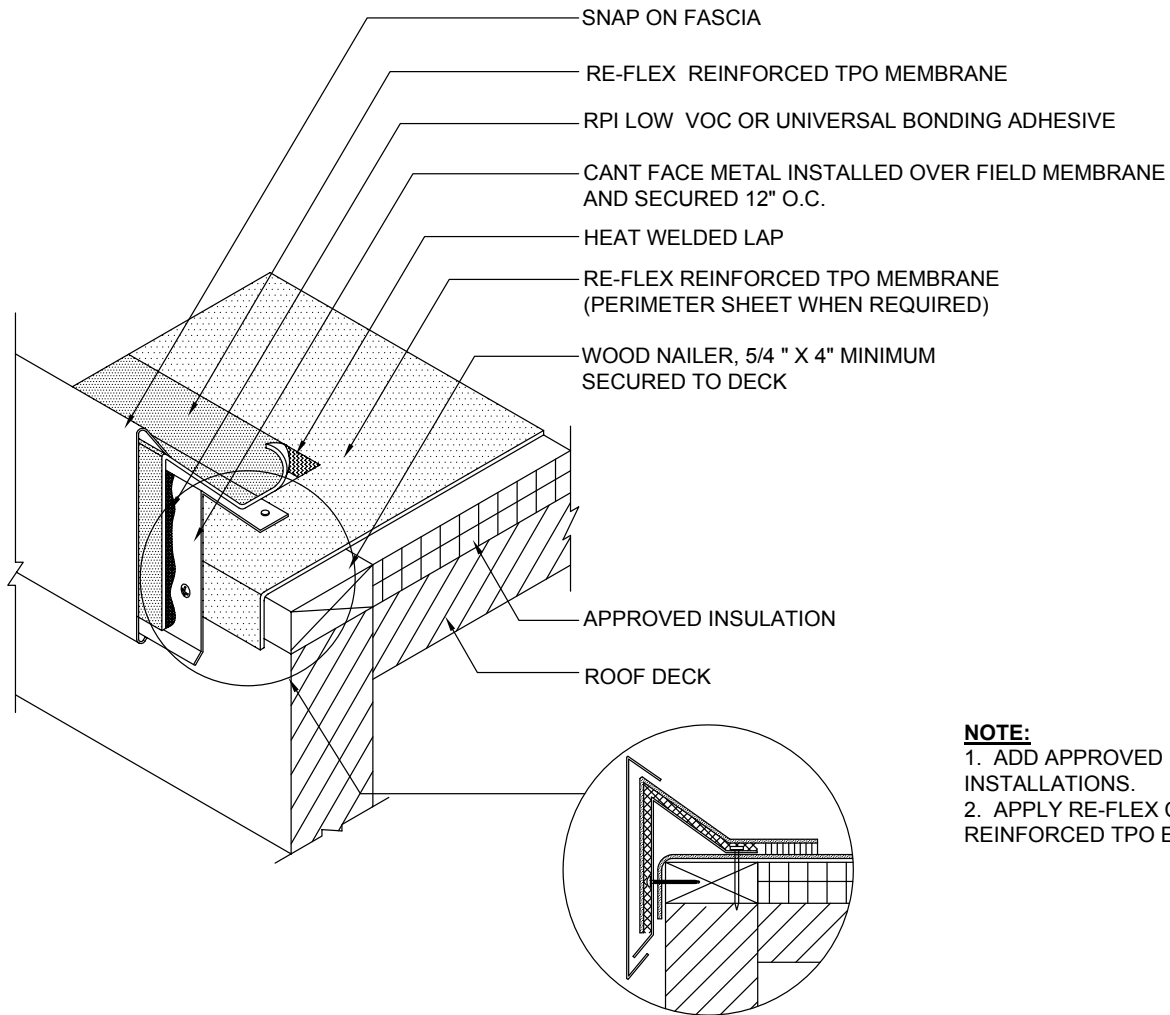

- NOTE:**
1. ADD APPROVED BALLAST PER BALLAST SYSTEM INSTALLATIONS.
 2. APPLY RE-FLEX CUT EDGE SEALANT TO ALL FIELD CUT REINFORCED TPO EDGES.

SNAP ON FASCIA METAL EDGE DETAIL

ACCEPTABLE WITH RE-FLEX TPO MECHANICALLY
ATTACHED OR BALLAST SYSTEMS

PROJECT:	SCALE
	NOT TO SCALE

Revision Date: 5-10-2015 #314



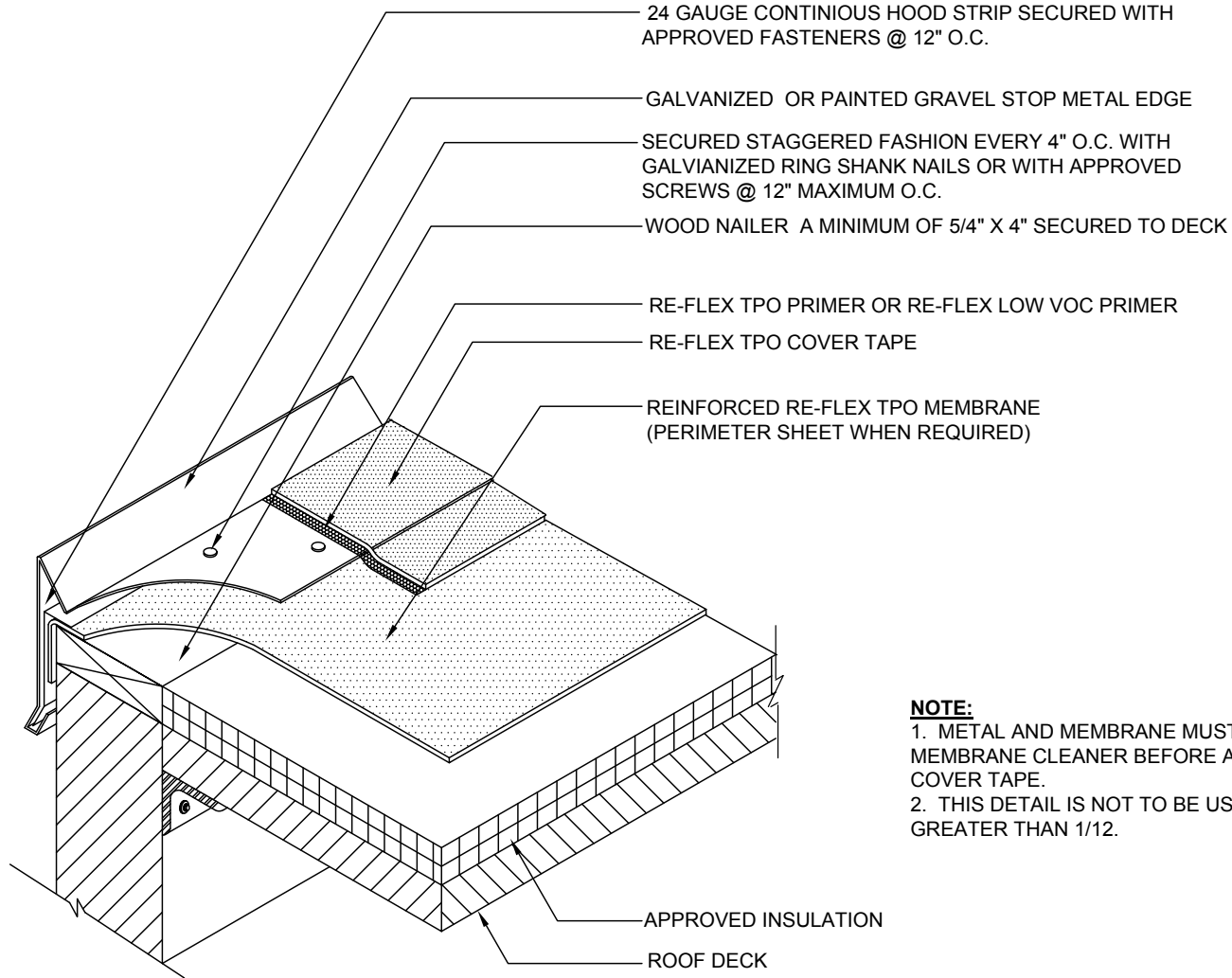

NOTE:

1. METAL AND MEMBRANE MUST BE CLEANED WITH MEMBRANE CLEANER BEFORE APPLYING PRIMER AND COVER TAPE.
2. THIS DETAIL IS NOT TO BE USED ON SLOPES GREATER THAN 1/12.

METAL EDGE WITH RE-FLEX TPO COVER TAPE DETAIL

ACCEPTABLE WITH RE-FLEX TPO MECHANICALLY ATTACHED SYSTEMS

PROJECT:

SCALE

NOT TO SCALE

Revision Date: 5-10-2015

#315



Roofing Products International, Inc.

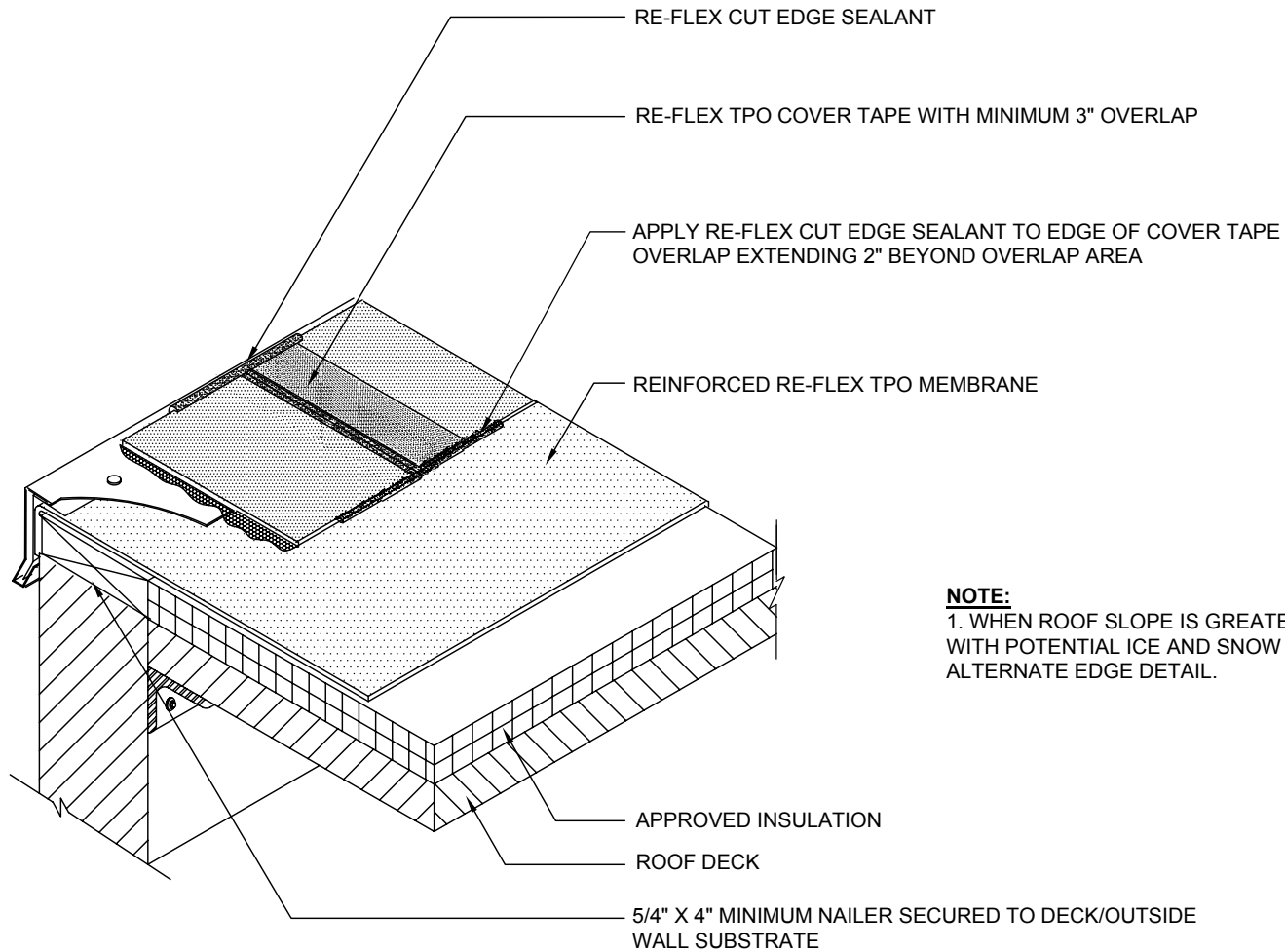

NOTE:
 1. WHEN ROOF SLOPE IS GREATER THAN 1:12 IN CLIMATES WITH POTENTIAL ICE AND SNOW BUILD-UP, REFER TO THE ALTERNATE EDGE DETAIL.

RE-FLEX TPO COVER TAPE OVERLAP AT METAL EDGE DETAIL

ACCEPTABLE WITH RE-FLEX TPO MECHANICALLY ATTACHED SYSTEMS

PROJECT:

SCALE

NOT TO SCALE

Revision Date: 5-10-2015

#316



Roofing Products International, Inc.

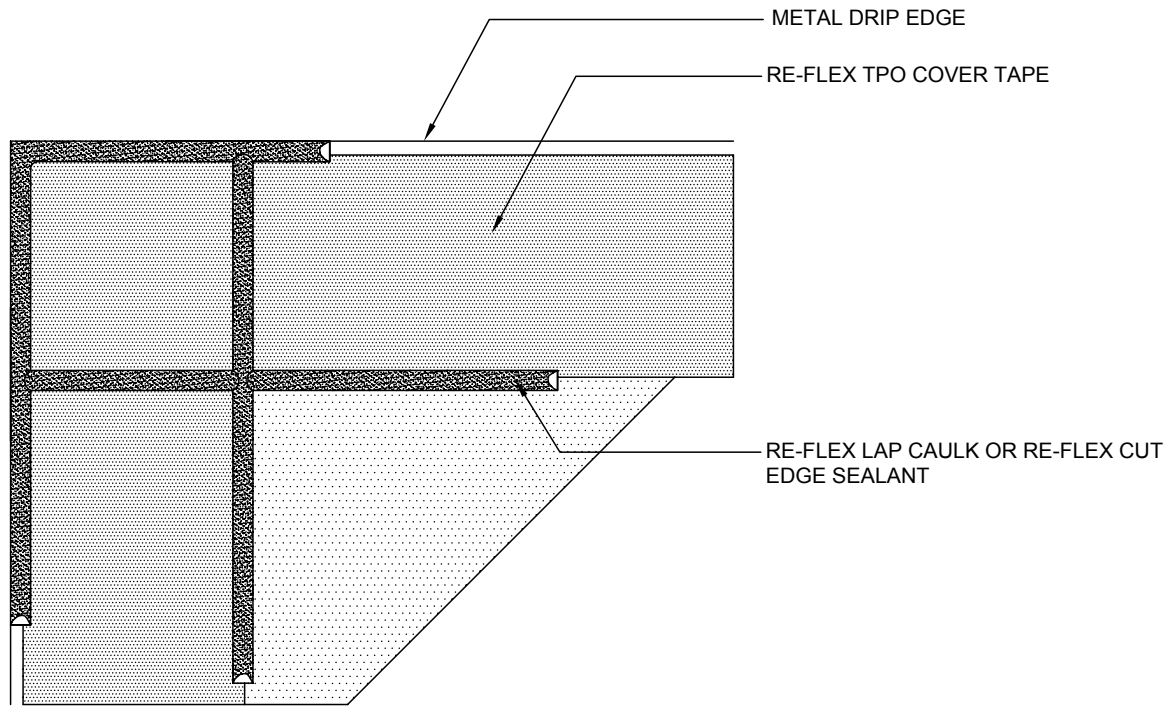

NOTE:
 APPLY RE-FLEX LAP CAULK OR RE-FLEX CUT EDGE SEALANT TO ALL FIELD CUT REINFORCED MEMBRANE EDGES. REFER TO CUT EDGE SEALANT OR RE-FLEX LAP CAULK DETAIL.

RE-FLEX TPO COVER TAPE ON METAL EDGE - CORNER CAULK DETAIL

ACCEPTABLE WITH RE-FLEX TPO MECHANICALLY ATTACHED SYSTEMS	
PROJECT:	SCALE
	NOT TO SCALE
Revision Date: 5-10-2015	#317



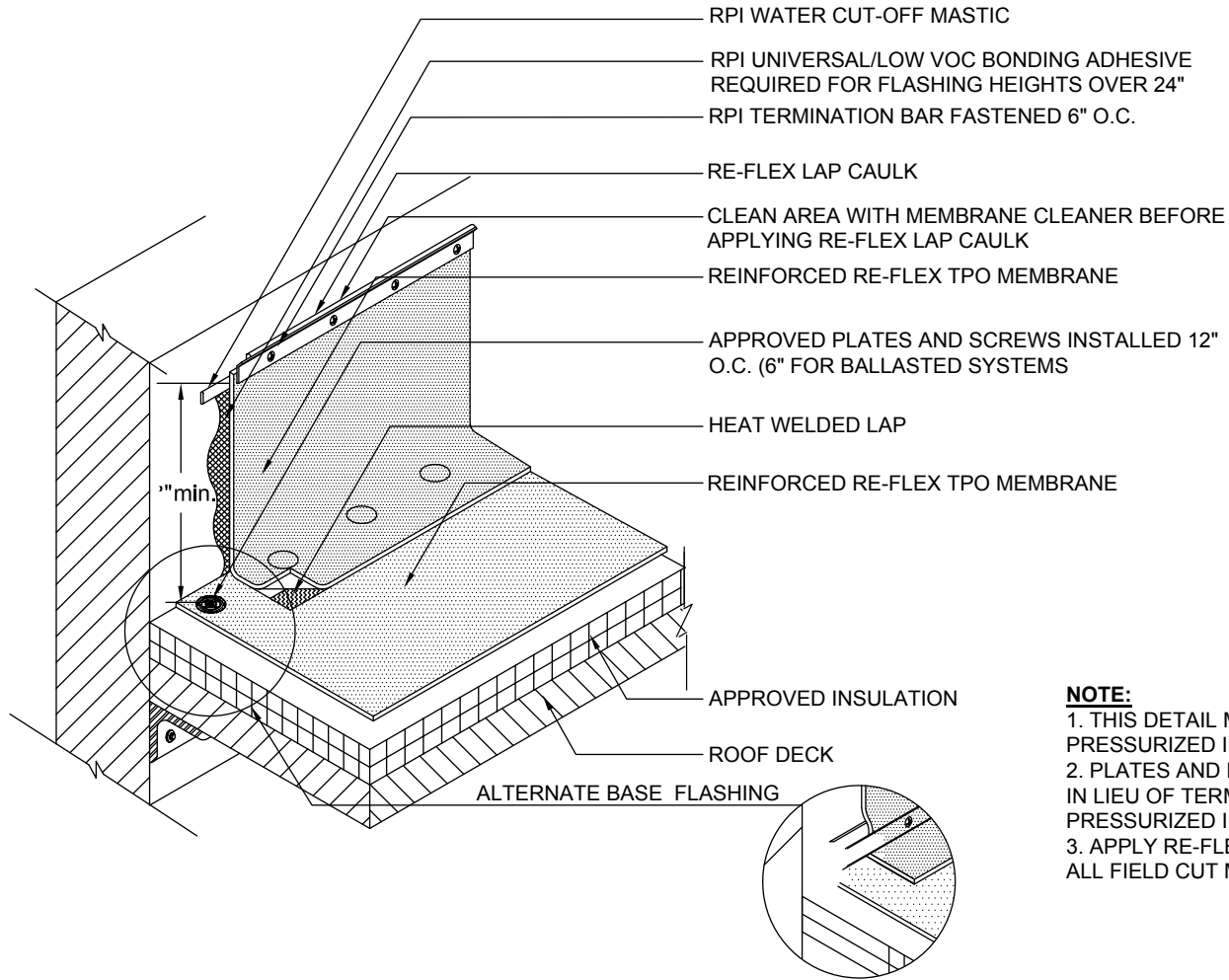

VERTICAL WALL FLASHING FASTENING KEY
54" MAXIMUM ADHESIVE 24" MAXIMUM DRY (MECHANICALLY ATTACHED)

- NOTE:**
1. THIS DETAIL MUST BE USED FOR PRESSURIZED INSTALLATIONS.
 2. PLATES AND FASTENERS MAY BE USED IN LIEU OF TERMINATION BAR IN NON-PRESSURIZED INSTALLATIONS.
 3. APPLY RE-FLEX CUT EDGE SEALANT TO ALL FIELD CUT MEMBRANE EDGES.

RE-FLEX TPO ADHERED WALL/CURB FLASHING WITH TERMINATION BAR DETAIL

ACCEPTABLE WITH RE-FLEX TPO MECHANICALLY ATTACHED SYSTEMS	
PROJECT:	SCALE
	NOT TO SCALE
Revision Date: 5-10-2015	#318



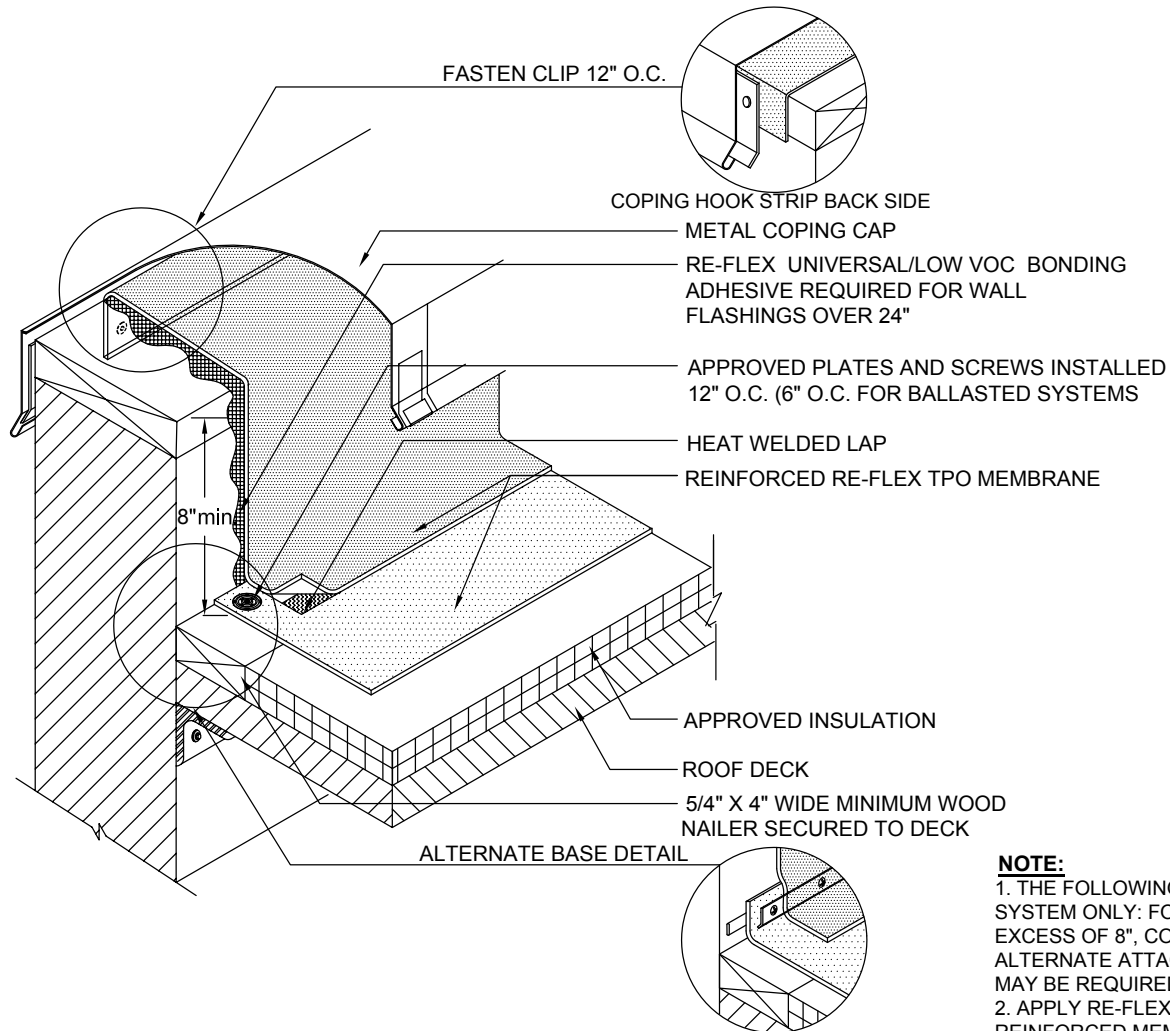

MECHANICAL FASTENING KEY
24" FOR DRY FLASHING
54" FOR ADHERED

NOTE:

1. THE FOLLOWING APPLIES TO MECHANICALLY ATTACHED SYSTEM ONLY: FOR INSTALLATIONS REQUIRING INSULATION IN EXCESS OF 8", CONTACT RPI TECHNICAL SERVICES FOR ALTERNATE ATTACHEMENT REQUIREMENTS. A BARRIER BOARD MAY BE REQUIRED.
2. APPLY RE-FLEX CUT EDGE SEALANT TO ALL FIELD CUT REINFORCED MEMBRANE EDGES.

**WALL FLASHING WITH METAL CAP
DETAIL**

ACCEPTABLE WITH RE-FLEX TPO MECHANICALLY ATTACHED SYSTEMS	
PROJECT:	SCALE
	NOT TO SCALE
Revision Date: 5-10-2015	#319



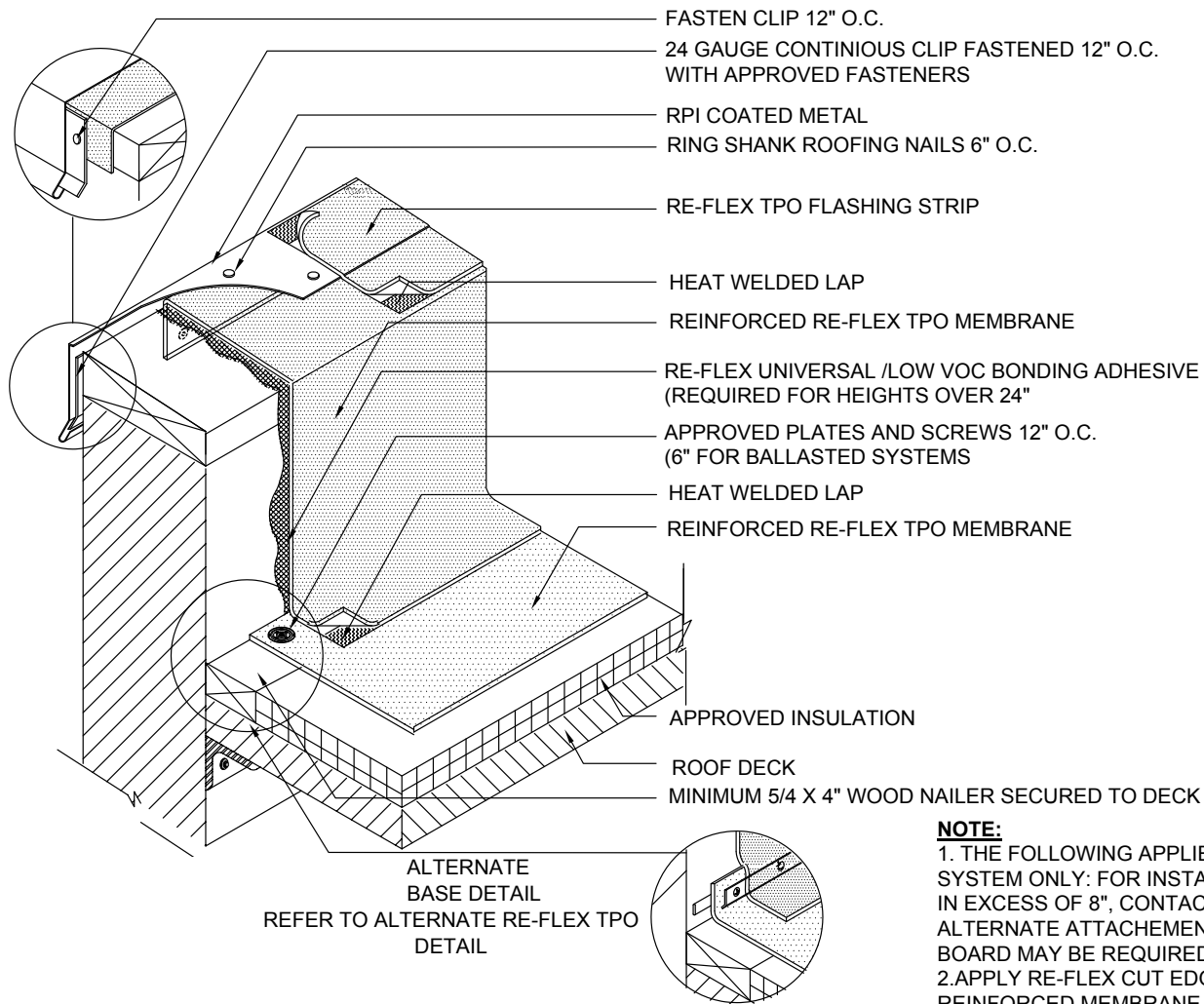

NOTE:

1. THE FOLLOWING APPLIES TO MECHANICALLY ATTACHED SYSTEM ONLY: FOR INSTALLATIONS REQUIRING INSULATION IN EXCESS OF 8", CONTACT RPI TECHNICAL SERVICES FOR ALTERNATE ATTACHMENT REQUIREMENTS. A BARRIER BOARD MAY BE REQUIRED.
2. APPLY RE-FLEX CUT EDGE SEALANT TO ALL FIELD CUT REINFORCED MEMBRANE EDGES.

RE-FLEX COATED METAL EDGE OVER WALL FLASHING DETAIL

ACCEPTABLE WITH RE-FLEX TPO MECHANICALLY ATTACHED SYSTEMS

PROJECT:

SCALE

NOT TO SCALE

Revision Date: 5-10-2015

#320



Roofing Products International, Inc.

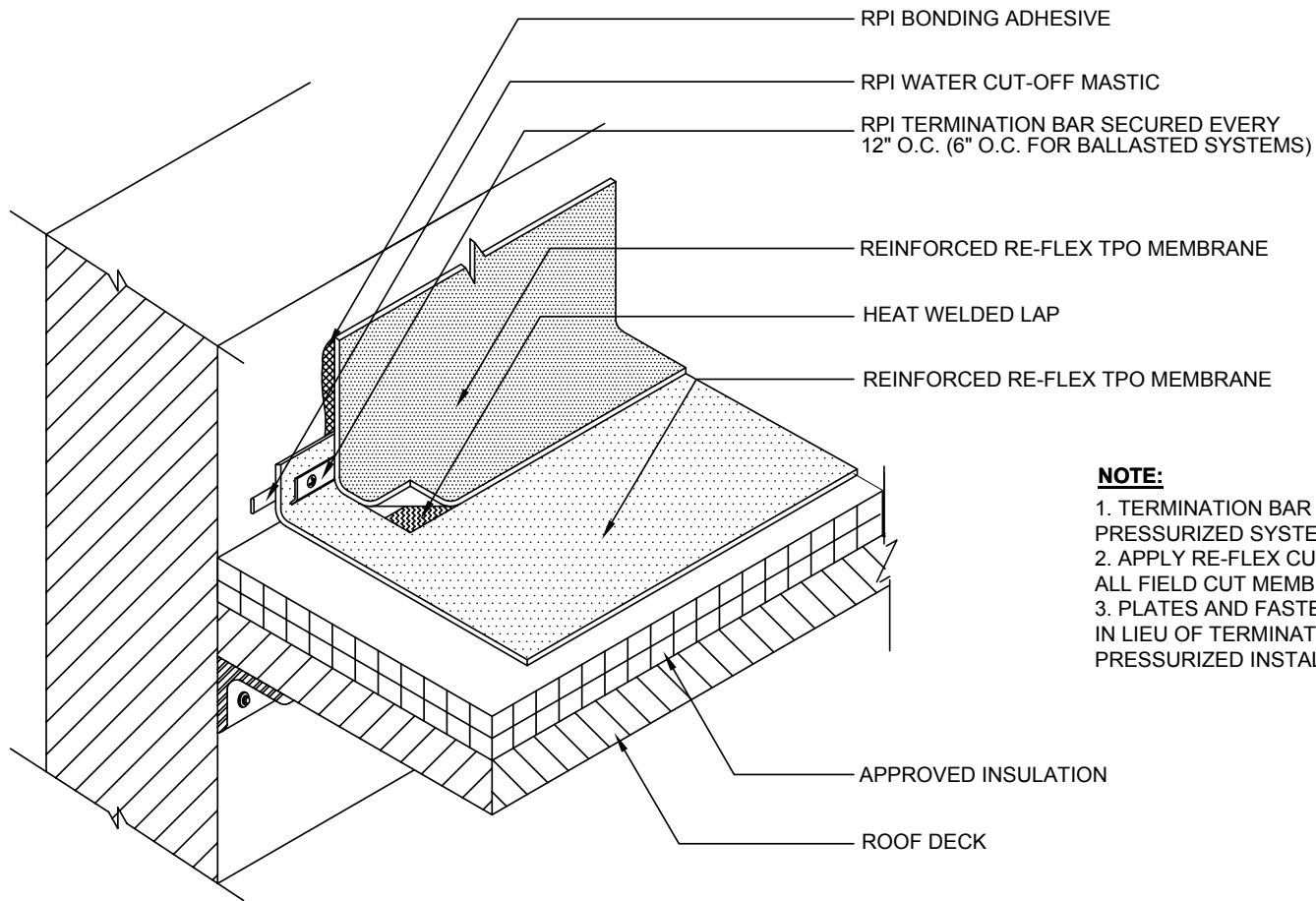

NOTE:

1. TERMINATION BAR MUST BE USED IN ALL PRESSURIZED SYSTEMS.
2. APPLY RE-FLEX CUT EDGE SEALANT TO ALL FIELD CUT MEMBRANE EDGES.
3. PLATES AND FASTENERS MAY BE USED IN LIEU OF TERMINATION BAR IN NON-PRESSURIZED INSTALLATIONS.

**ALTERNATE WALL/BASE
FLASHING TERMINATION DETAIL**

ACCEPTABLE WITH RE-FLEX TPO
MECHANICALLY ATTACHED SYSTEMS

PROJECT:

SCALE

NOT TO SCALE

Revision Date: 5-10-2015

#321



Roofing Products International, Inc.

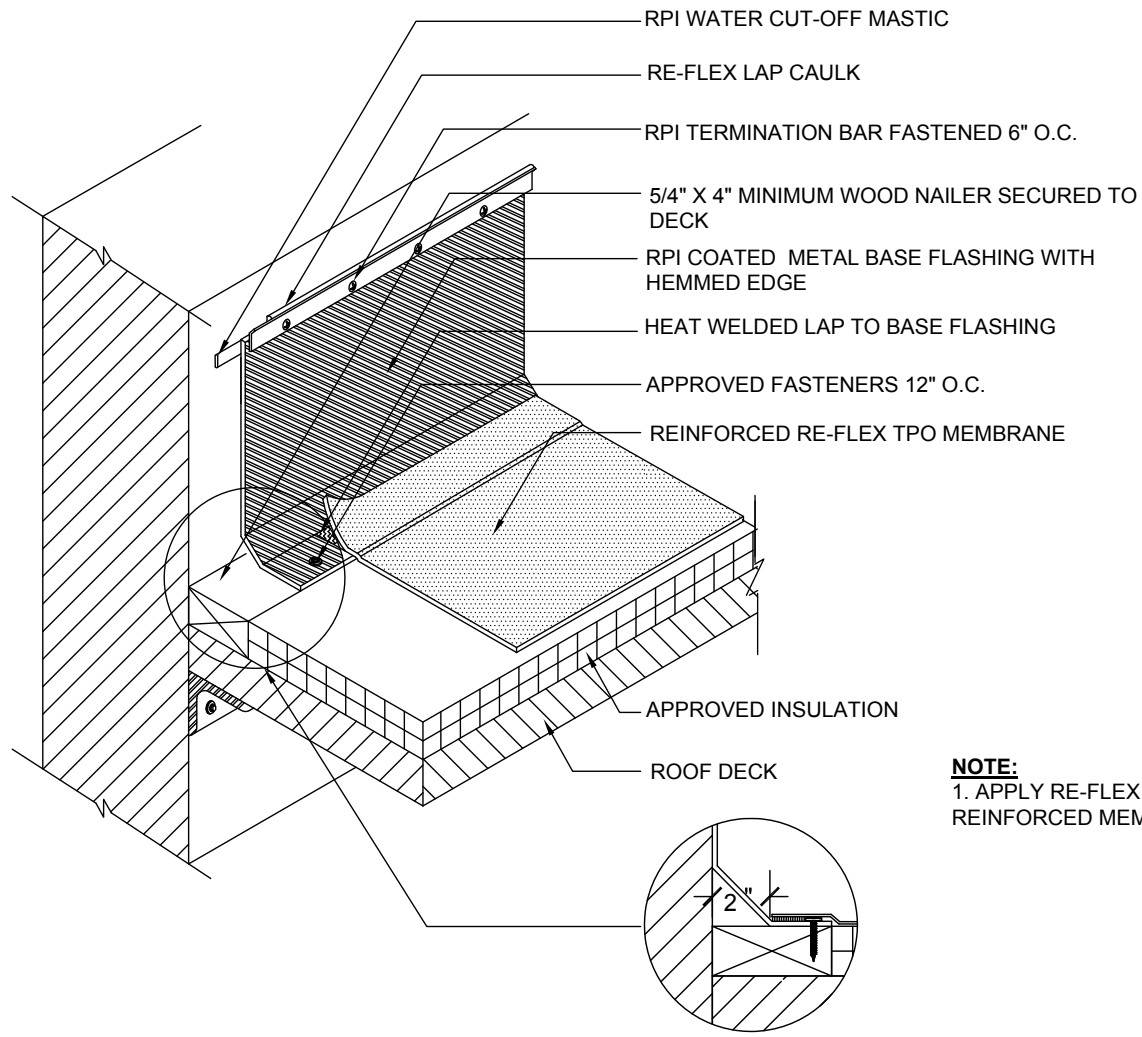

NOTE:
 1. APPLY RE-FLEX CUT-EDGE SEALANT TO ALL FIELD CUT REINFORCED MEMBRANE EDGES.

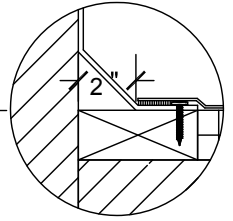

**COATED METAL WALL FLASHING
 DETAIL**

ACCEPTABLE WITH RE-FLEX TPO MECHANICALLY ATTACHED SYSTEMS	
PROJECT:	SCALE
	NOT TO SCALE
Revision Date: 5-10-2015	#322



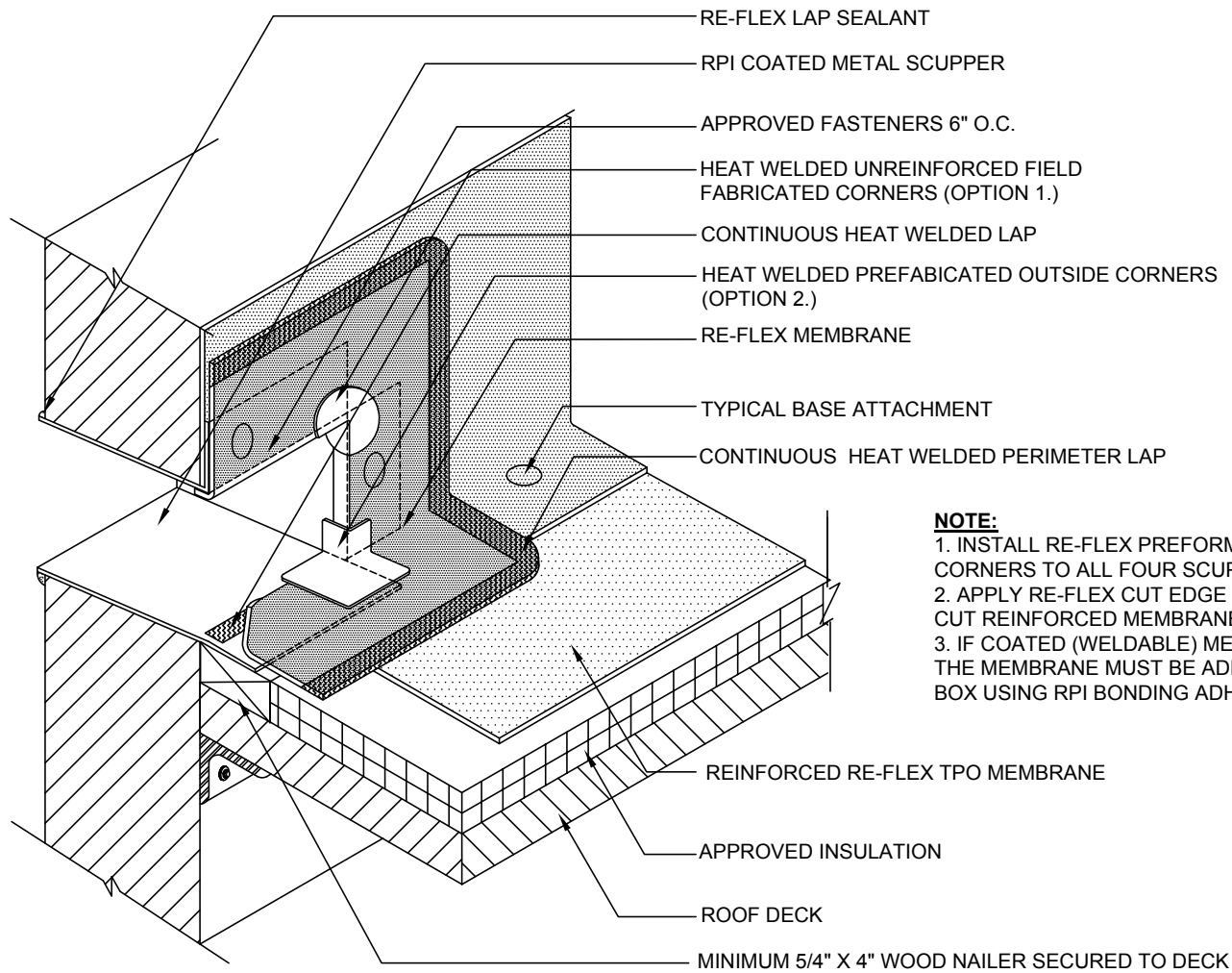

NOTE:

1. INSTALL RE-FLEX PREFORMED OR UNREINFORCED CORNERS TO ALL FOUR SCUPPER CORNERS.
2. APPLY RE-FLEX CUT EDGE SEALANT TO ALL FIELD CUT REINFORCED MEMBRANE EDGES.
3. IF COATED (WELDABLE) METAL IS NOT AN OPTION, THE MEMBRANE MUST BE ADHERED TO THE SCUPPER BOX USING RPI BONDING ADHESIVE.

COATED METAL SCUPPER WALL FLASHING DETAIL

ACCEPTABLE WITH RE-FLEX TPO MECHANICALLY ATTACHED SYSTEMS

PROJECT:

SCALE

NOT TO SCALE

Revision Date: 5-10-2015

#323



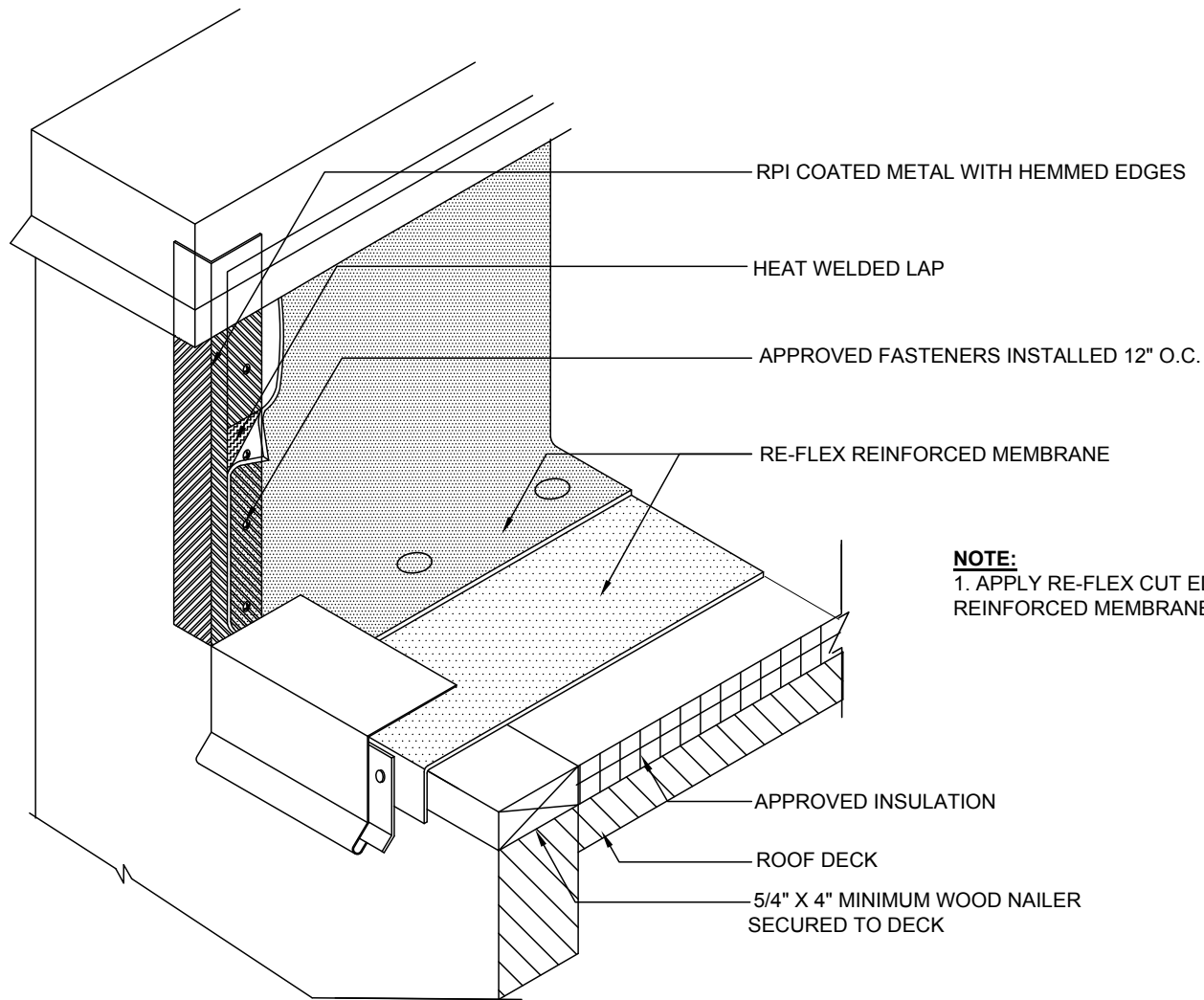

NOTE:
 1. APPLY RE-FLEX CUT EDGE SEALANT TO ALL FIELD CUT REINFORCED MEMBRANE EDGES.

**OUTSIDE CORNER WALL
 FLASHING WITH COATED METAL
 DETAIL**

ACCEPTABLE WITH RE-FLEX TPO MECHANICALLY ATTACHED SYSTEMS	
PROJECT:	SCALE
	NOT TO SCALE
Revision Date: 5-10-2015	#324



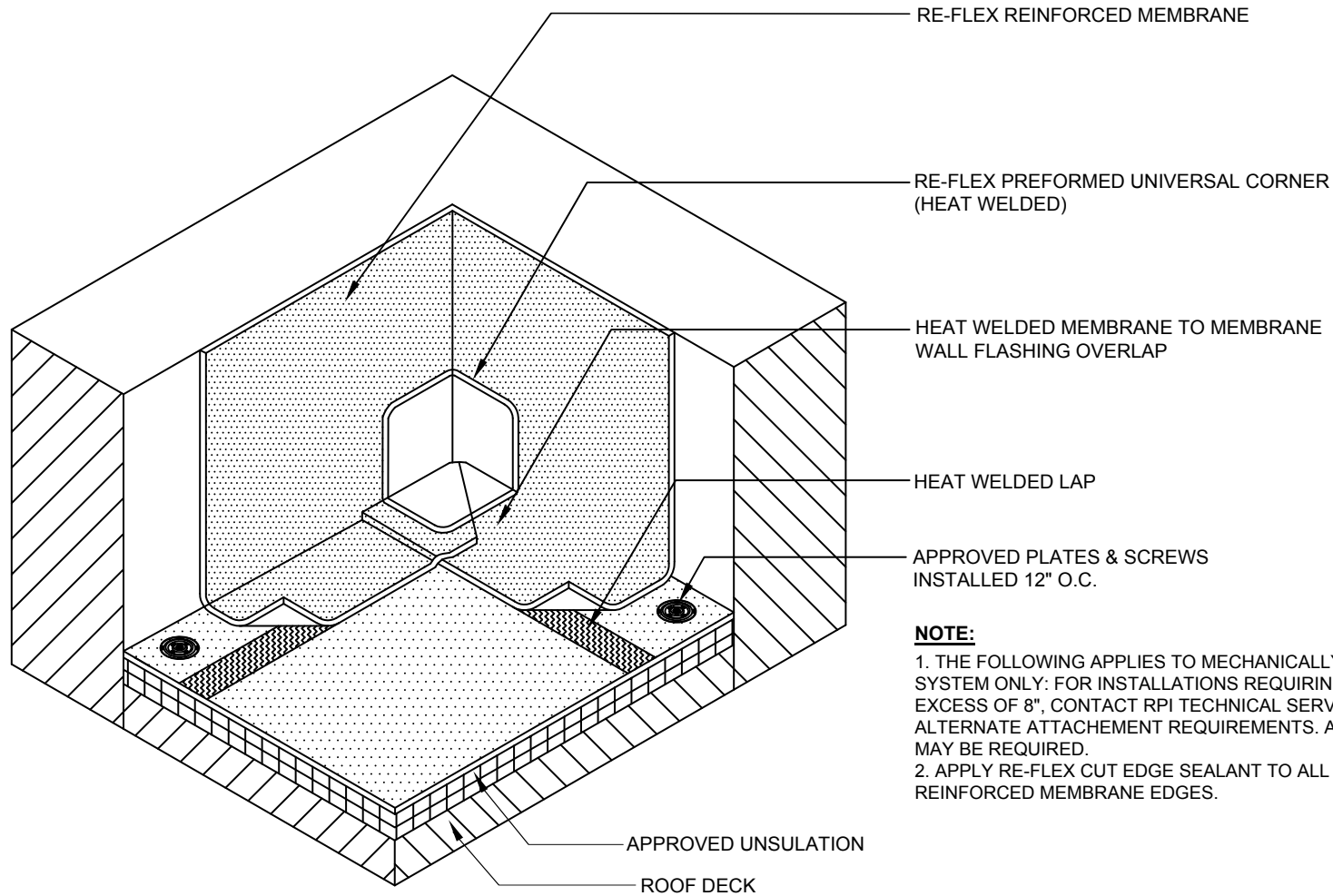

NOTE:

1. THE FOLLOWING APPLIES TO MECHANICALLY ATTACHED SYSTEM ONLY: FOR INSTALLATIONS REQUIRING INSULATION IN EXCESS OF 8", CONTACT RPI TECHNICAL SERVICES FOR ALTERNATE ATTACHEMENT REQUIREMENTS. A BARRIER BOARD MAY BE REQUIRED.
2. APPLY RE-FLEX CUT EDGE SEALANT TO ALL FIELD CUT REINFORCED MEMBRANE EDGES.

INSIDE CORNER PREFORMED FLASHING DETAIL

ACCEPTABLE WITH RE-FLEX TPO
MECHANICALLY ATTACHED SYSTEMS

PROJECT:

SCALE

NOT TO SCALE

Revision Date: 5-10-2015

#325



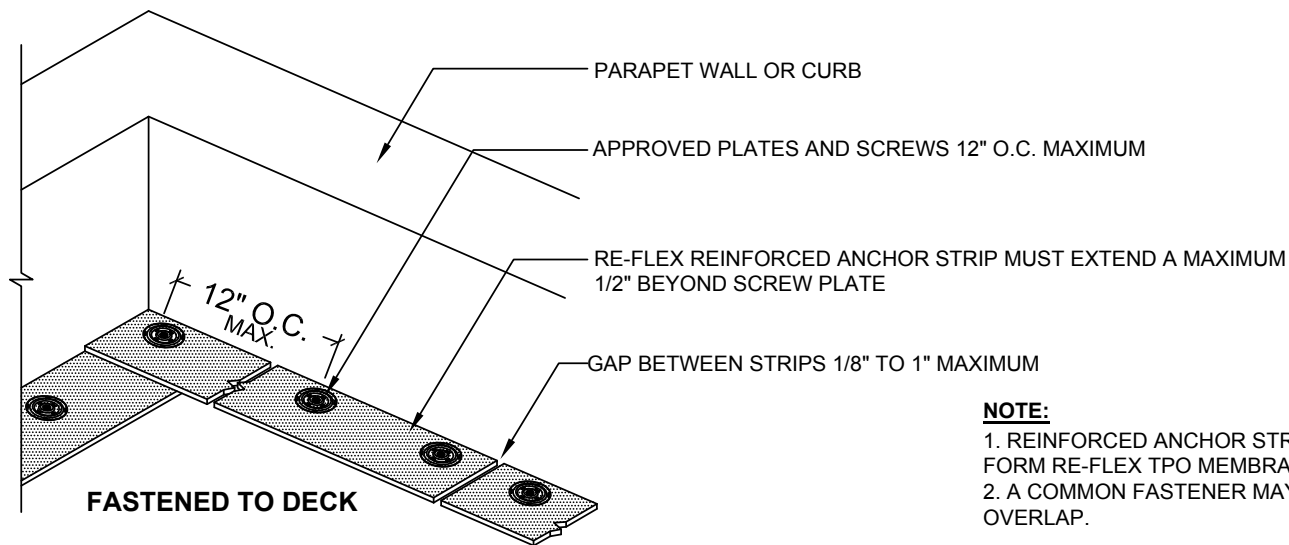
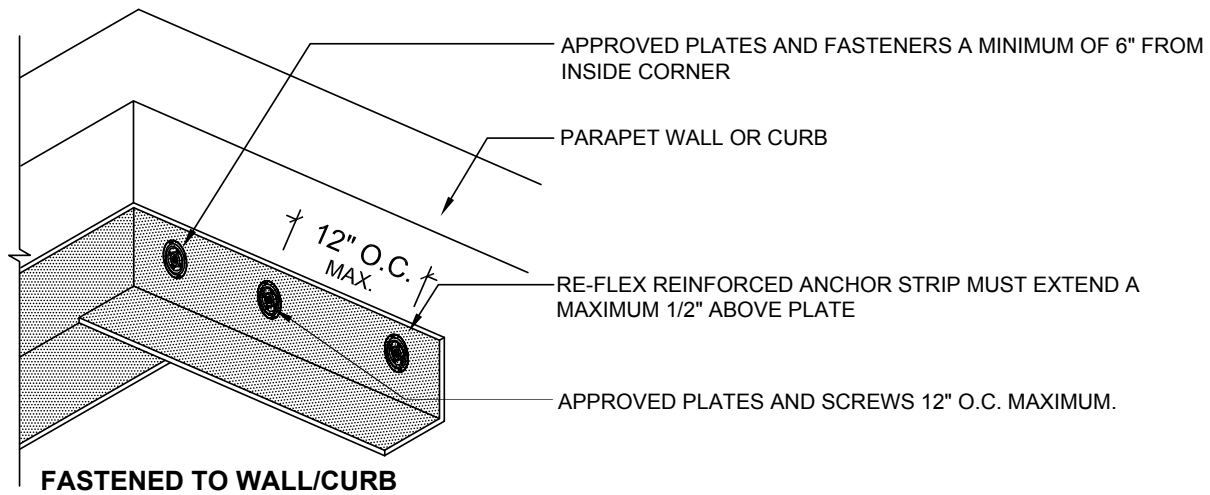

NOTE:
 1. REINFORCED ANCHOR STRIP MAY BE FIELD FABRICATED FORM RE-FLEX TPO MEMBRANE.
 2. A COMMON FASTENER MAY BE USED ON CORNER OVERLAP.

REINFORCED ANCHOR STRIP INSIDE WALL DETAIL

ACCEPTABLE WITH RE-FLEX TPO
MECHANICALLY ATTACHED SYSTEMS

PROJECT:

SCALE

NOT TO SCALE

Revision Date: 5-10-2015

#326



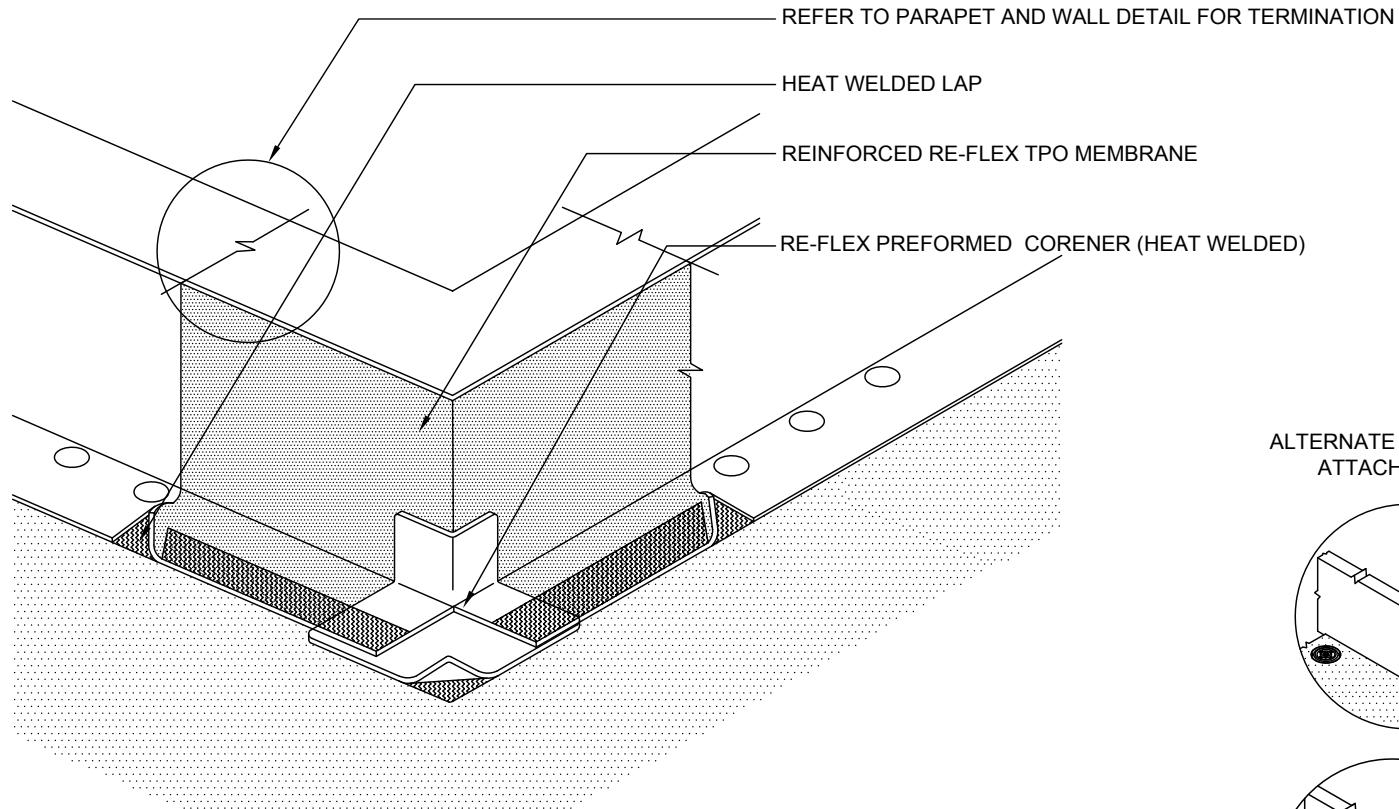

ALTERNATE WALL/CURB ATTACHEMENT

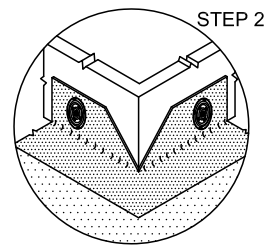
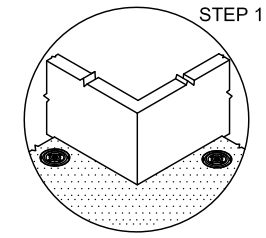

NOTE:

1. OUTSIDE CORNERS MAY ALSO BE FIELD FABRICATED USING UNREINFORCED MEMBRANE.
2. BEGIN INSTALLATING FASTENER PLATES 6" FROM CORNER. KEEP FASTENERS APPROX. 6" FROM HORIZONTAL AND VERTICAL APPLICATIONS.
3. FLASHINGS MAY BE ADHERED OR INSTALLED DRY, REFER TO SPECIFICATIONS.
4. APPLY RE-FLEX CUT EDGE SEALANT TO ALL FIELD CUT REINFORCED MEMBRANE EDGES.

OUTSIDE CORNER PREFORMED FLASHING DETAIL

ACCEPTABLE WITH RE-FLEX TPO MECHANICALLY ATTACHED SYSTEMS	
PROJECT:	SCALE
	NOT TO SCALE
Revision Date: 5-10-2015	#327



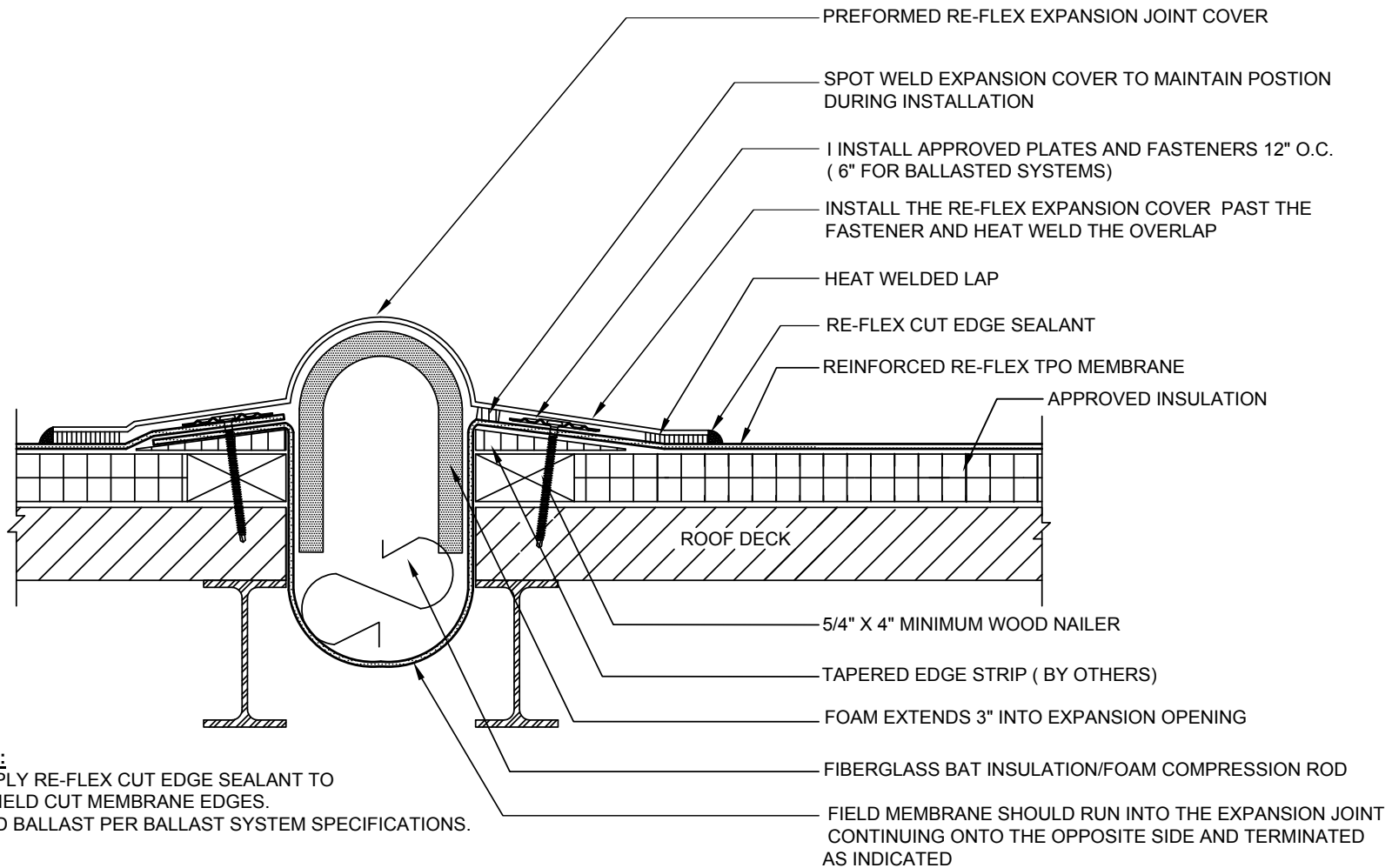

NOTE:

1. APPLY RE-FLEX CUT EDGE SEALANT TO ALL FIELD CUT MEMBRANE EDGES.
2. ADD BALLAST PER BALLAST SYSTEM SPECIFICATIONS.

PREFORMED RE-FLEX EXPANSION JOINT DETAIL-FLAT INSTALLATION

ACCEPTABLE WITH RE-FLEX TPO MECHANICALLY ATTACHED SYSTEMS

PROJECT:

SCALE

NOT TO SCALE

Revision Date: 5-10-2015

#328



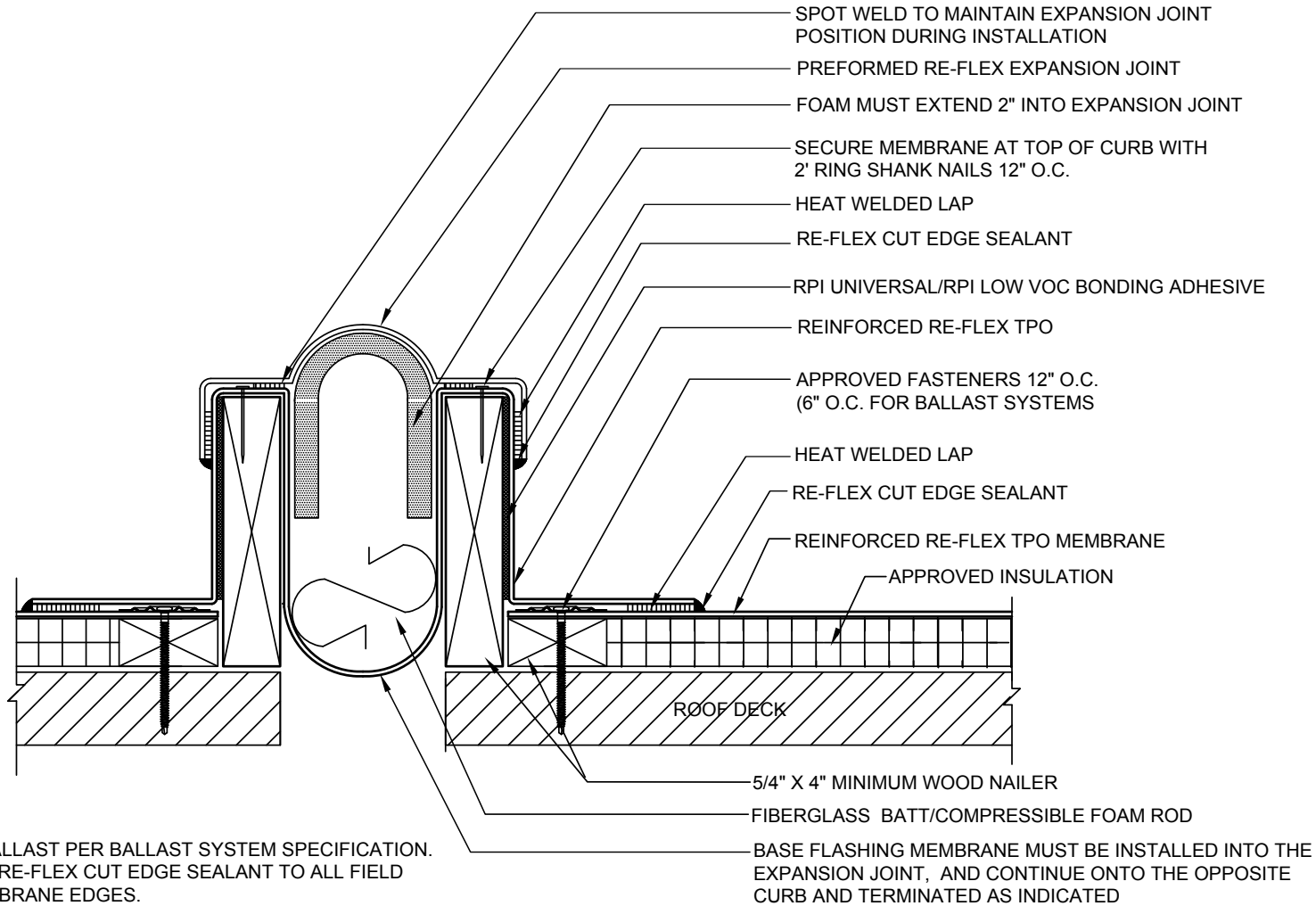

NOTE:

1. ADD BALLAST PER BALLAST SYSTEM SPECIFICATION.
2. APPLY RE-FLEX CUT EDGE SEALANT TO ALL FIELD CUT MEMBRANE EDGES.

**PREFORMED RE-FLEX EXPANSION
JOINT DETAIL-CURB
INSTALLATION**

ACCEPTABLE WITH RE-FLEX TPO
MECHANICALLY ATTACHED SYSTEMS

PROJECT:

SCALE

NOT TO SCALE

Revision Date: 5-10-2015

#329



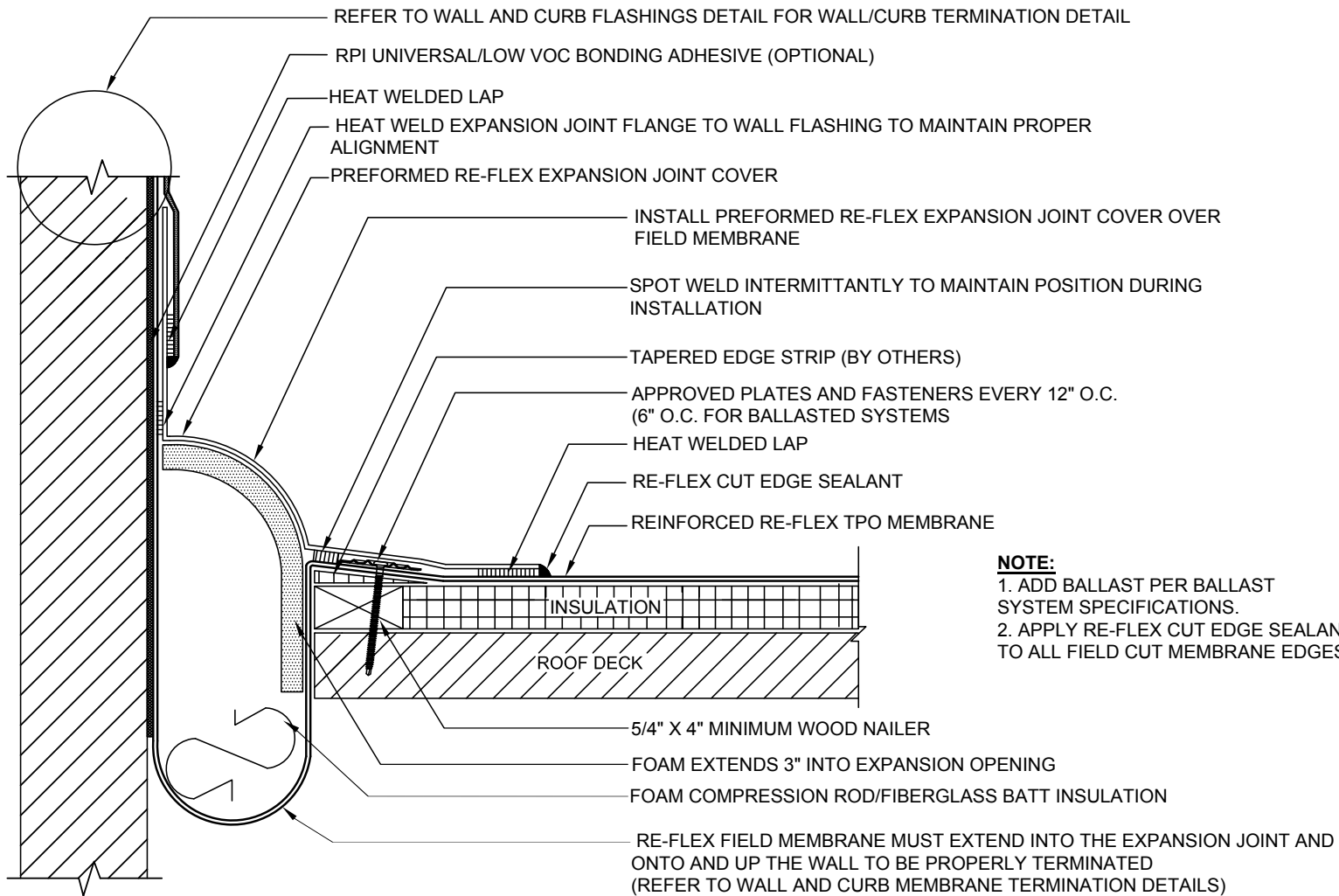

NOTE:
 1. ADD BALLAST PER BALLAST SYSTEM SPECIFICATIONS.
 2. APPLY RE-FLEX CUT EDGE SEALANT TO ALL FIELD CUT MEMBRANE EDGES.

PREFORMED RE-FLEX EXPANSION JOINT WALL DETAIL-FLAT INSTALLATION

ACCEPTABLE WITH RE-FLEX TPO MECHANICALLY ATTACHED SYSTEMS

PROJECT:

SCALE

NOT TO SCALE

Revision Date: 5-10-2015

#330

RPI
 Roofing Products International, Inc.

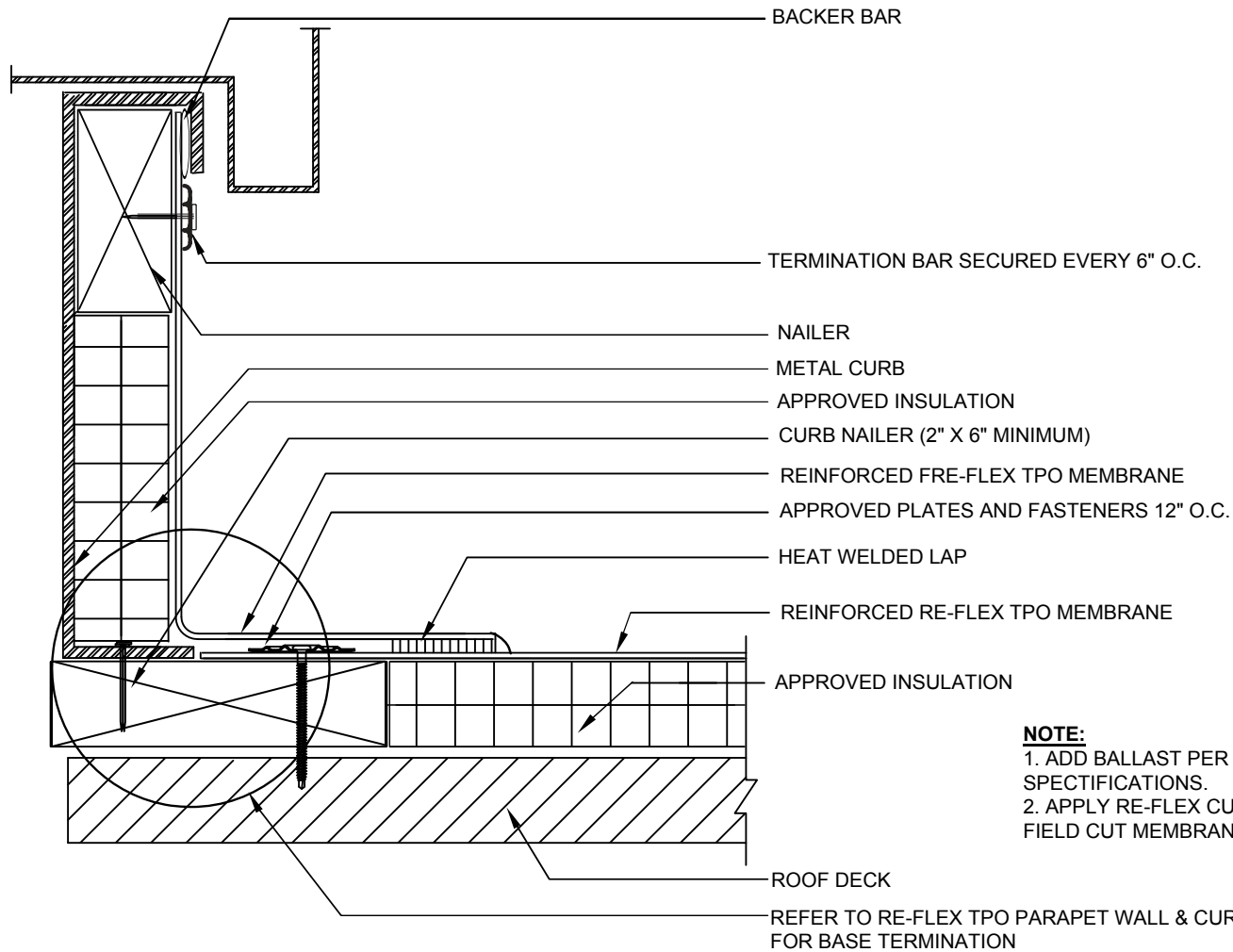

NOTE:
 1. ADD BALLAST PER BALLAST SYSTEM SPECIFICATIONS.
 2. APPLY RE-FLEX CUT EDGE SEALANT TO ALL FIELD CUT MEMBRANE EDGES.

INSULATED METAL CURB FLASHING TERMINATION DETAIL

ACCEPTABLE WITH RE-FLEX TPO
 MECHANICALLY ATTACHED SYSTEMS

PROJECT:

SCALE

NOT TO SCALE

Revision Date: 5-10-2015

#331



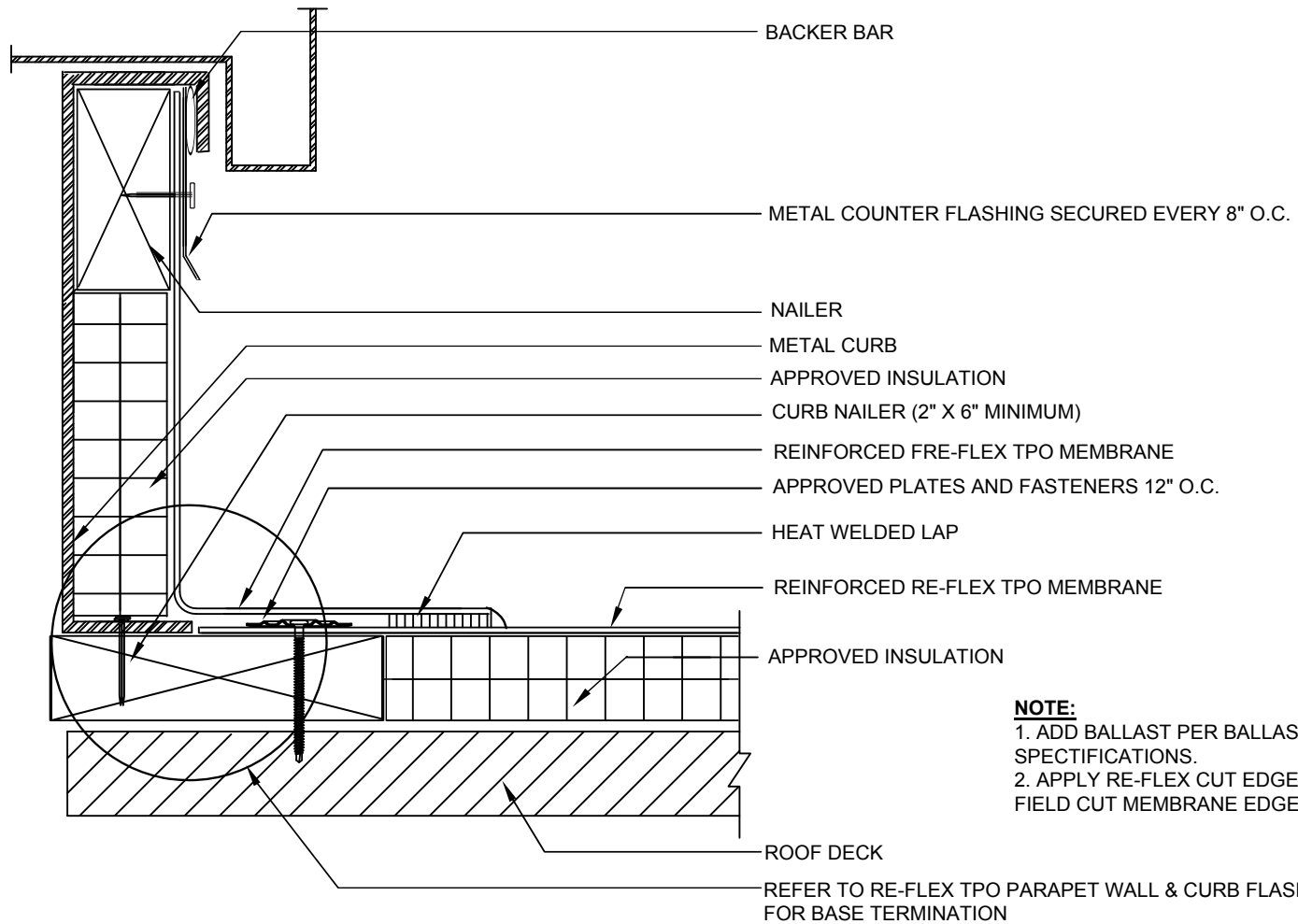

NOTE:
 1. ADD BALLAST PER BALLAST SYSTEM SPECIFICATIONS.
 2. APPLY RE-FLEX CUT EDGE SEALANT TO ALL FIELD CUT MEMBRANE EDGES.

**INSULATED METAL CURB WITH
 COUNTER FLASHING TERMINATION
 DETAIL**

ACCEPTABLE WITH RE-FLEX TPO
 MECHANICALLY ATTACHED SYSTEMS

PROJECT:

SCALE

NOT TO SCALE

Revision Date: 5-10-2015

#332



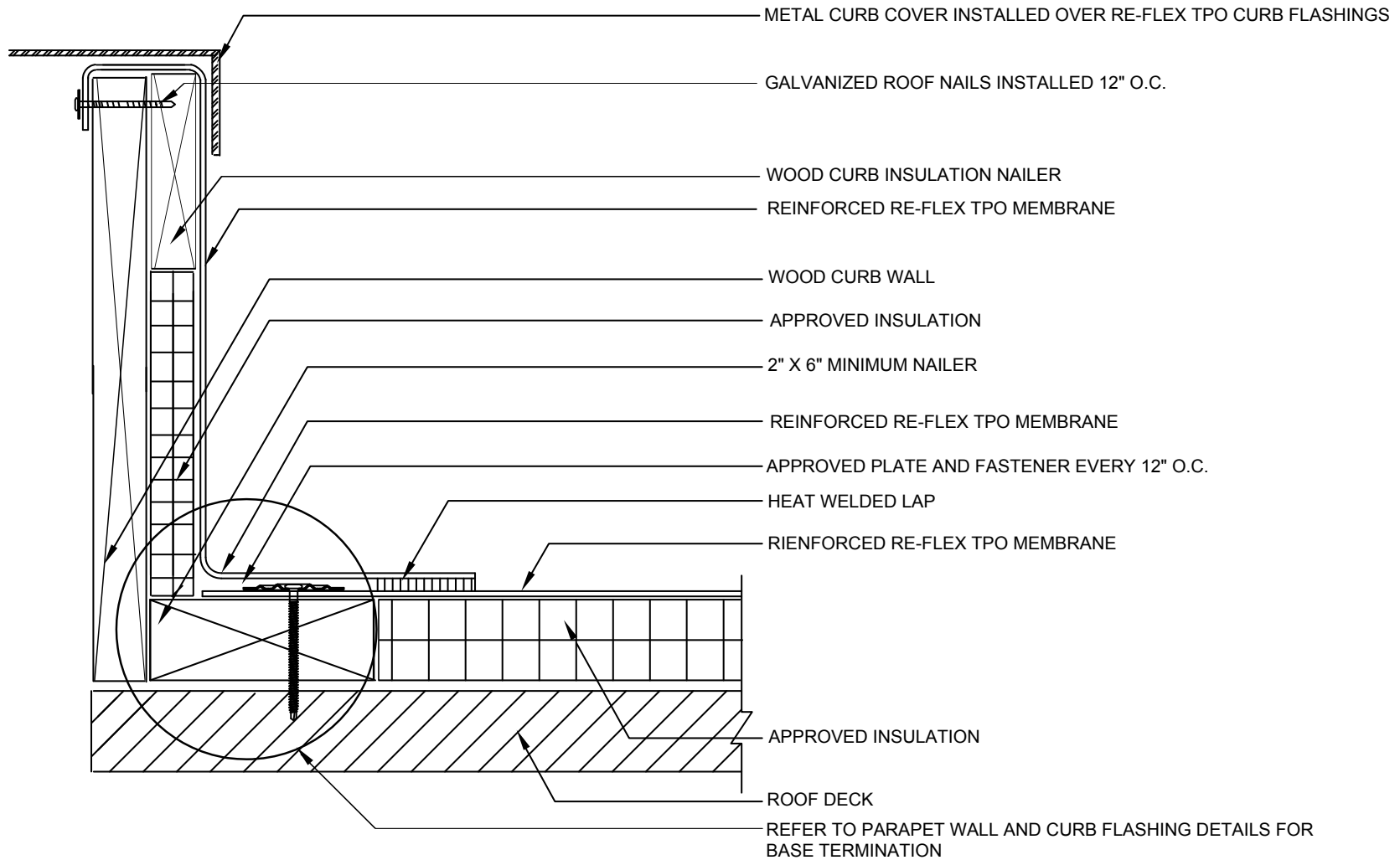

WOOD CURB WALL FLASHING DETAIL

ACCEPTABLE WITH RE-FLEX TPO
MECHANICALLY ATTACHED SYSTEMS

PROJECT:

SCALE

NOT TO SCALE

Revision Date: 5-10-2015

#333



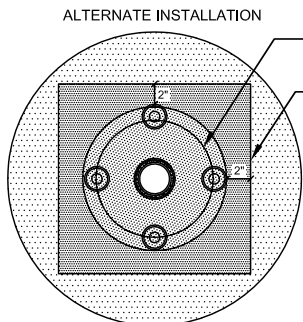

SEE NOTE #2

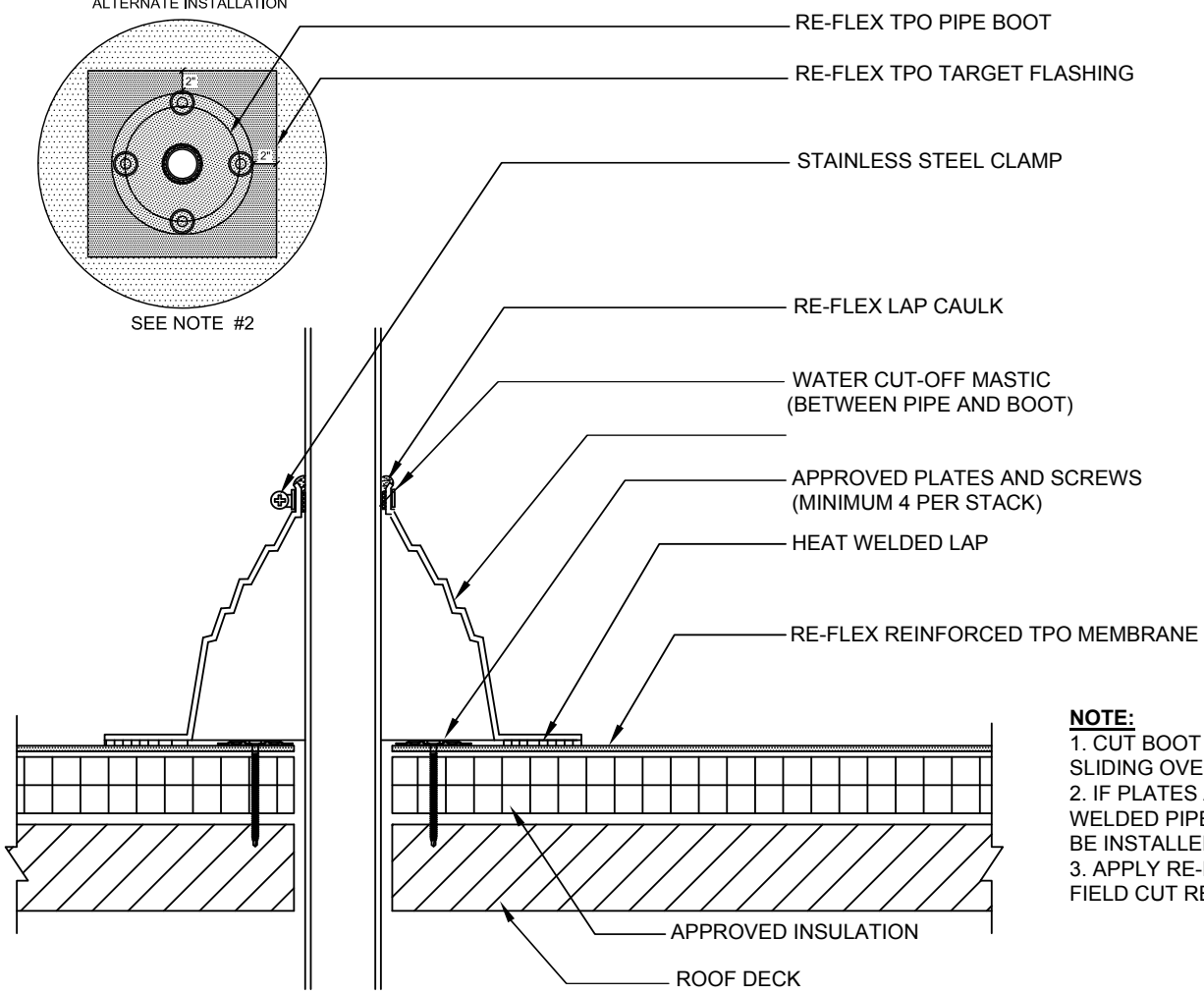

- NOTE:**
1. CUT BOOT TO ALLOW FOR SNUG FIT WHEN SLIDING OVER PIPE.
 2. IF PLATES AND FASTENERS INTRUDE UNDER WELDED PIPE FLANGE, A TARGET PATCH MUST BE INSTALLED EXTENDING 2" PAST THE PLATES.
 3. APPLY RE-FLEX CUT EDGE SEALANT TO ALL FIELD CUT REINFORCED MEMBRANE EDGES.

PREFORMED PIPE BOOT FLASHING DETAIL

ACCEPTABLE WITH RE-FLEX TPO MECHANICALLY ATTACHED SYSTEMS	
PROJECT:	SCALE
	NOT TO SCALE
Revision Date: 5-10-2015	#334



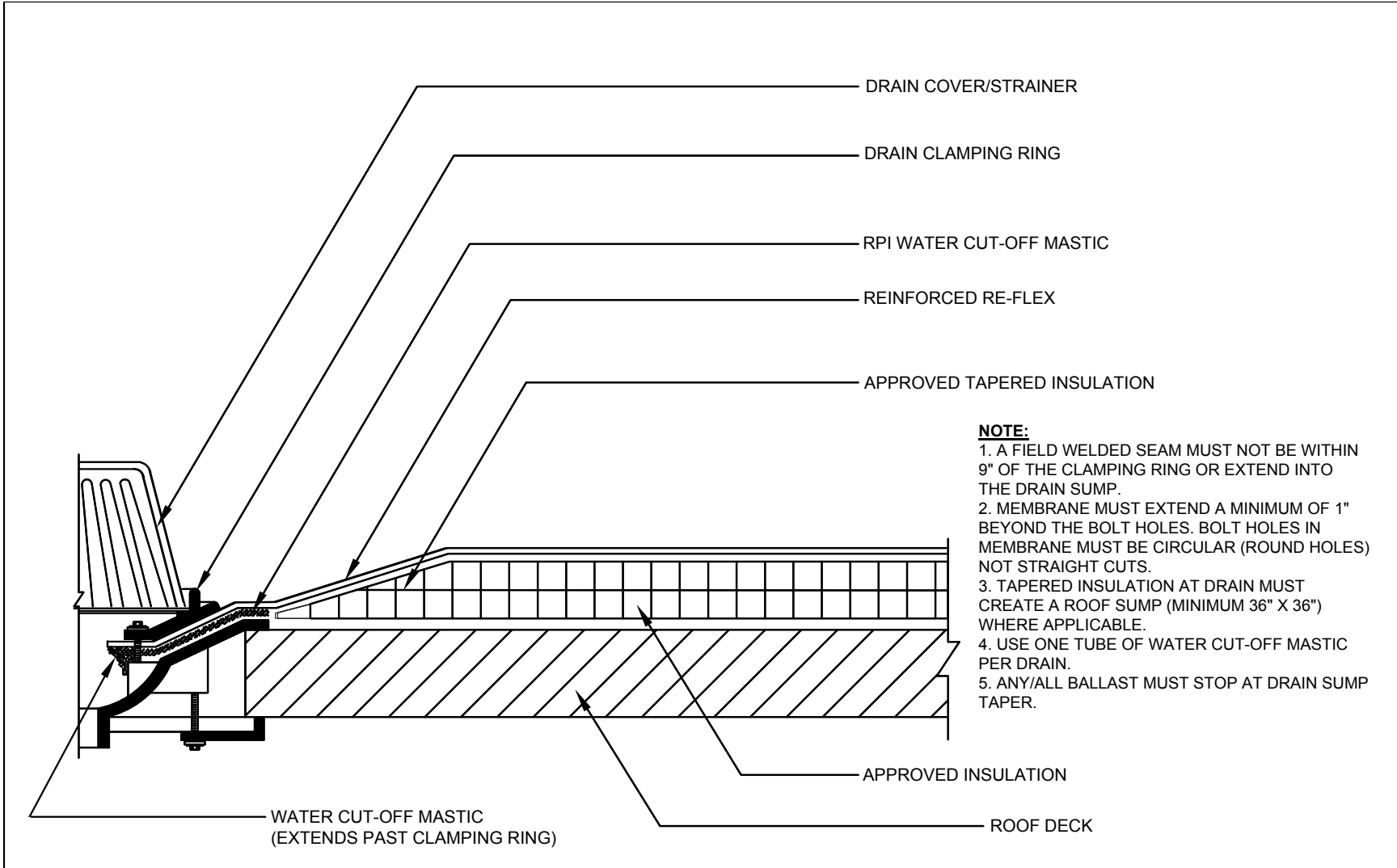

- NOTE:**
1. A FIELD WELDED SEAM MUST NOT BE WITHIN 9" OF THE CLAMPING RING OR EXTEND INTO THE DRAIN SUMP.
 2. MEMBRANE MUST EXTEND A MINIMUM OF 1" BEYOND THE BOLT HOLES. BOLT HOLES IN MEMBRANE MUST BE CIRCULAR (ROUND HOLES) NOT STRAIGHT CUTS.
 3. TAPERED INSULATION AT DRAIN MUST CREATE A ROOF SUMP (MINIMUM 36" X 36") WHERE APPLICABLE.
 4. USE ONE TUBE OF WATER CUT-OFF MASTIC PER DRAIN.
 5. ANY/ALL BALLAST MUST STOP AT DRAIN SUMP TAPER.

DRAIN WITH CLAMPING RING FLASHING DETAIL

ACCEPTABLE WITH RE-FLEX TPO MECHANICALLY ATTACHED SYSTEMS	
PROJECT:	SCALE
	NOT TO SCALE
Revision Date: 5-10-2015	#335



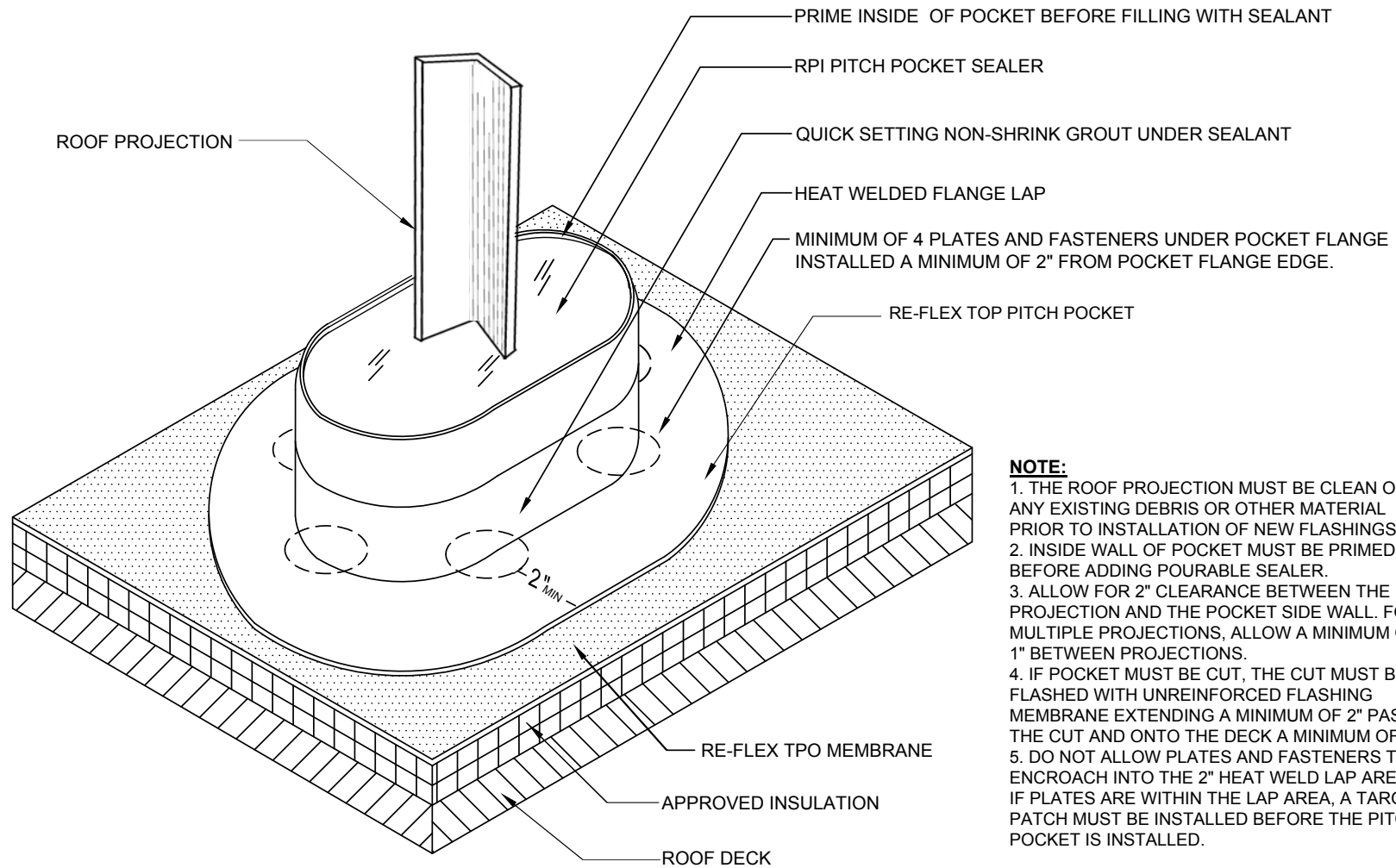

NOTE:

1. THE ROOF PROJECTION MUST BE CLEAN OF ANY EXISTING DEBRIS OR OTHER MATERIAL PRIOR TO INSTALLATION OF NEW FLASHINGS.
2. INSIDE WALL OF POCKET MUST BE PRIMED BEFORE ADDING POURABLE SEALER.
3. ALLOW FOR 2" CLEARANCE BETWEEN THE PROJECTION AND THE POCKET SIDE WALL. FOR MULTIPLE PROJECTIONS, ALLOW A MINIMUM OF 1" BETWEEN PROJECTIONS.
4. IF POCKET MUST BE CUT, THE CUT MUST BE FLASHED WITH UNREINFORCED FLASHING MEMBRANE EXTENDING A MINIMUM OF 2" PAST THE CUT AND ONTO THE DECK A MINIMUM OF 2".
5. DO NOT ALLOW PLATES AND FASTENERS TO ENCROACH INTO THE 2" HEAT WELD LAP AREA. IF PLATES ARE WITHIN THE LAP AREA, A TARGET PATCH MUST BE INSTALLED BEFORE THE PITCH POCKET IS INSTALLED.

POURABLE PITCH POCKET DETAIL

ACCEPTABLE WITH RE-FLEX TPO FULLY ADHERED AND MECHANICALLY ATTACHED SYSTEMS

PROJECT:

SCALE

NOT TO SCALE

Revision Date: 5-10-2015

#336



Roofing Products International, Inc.

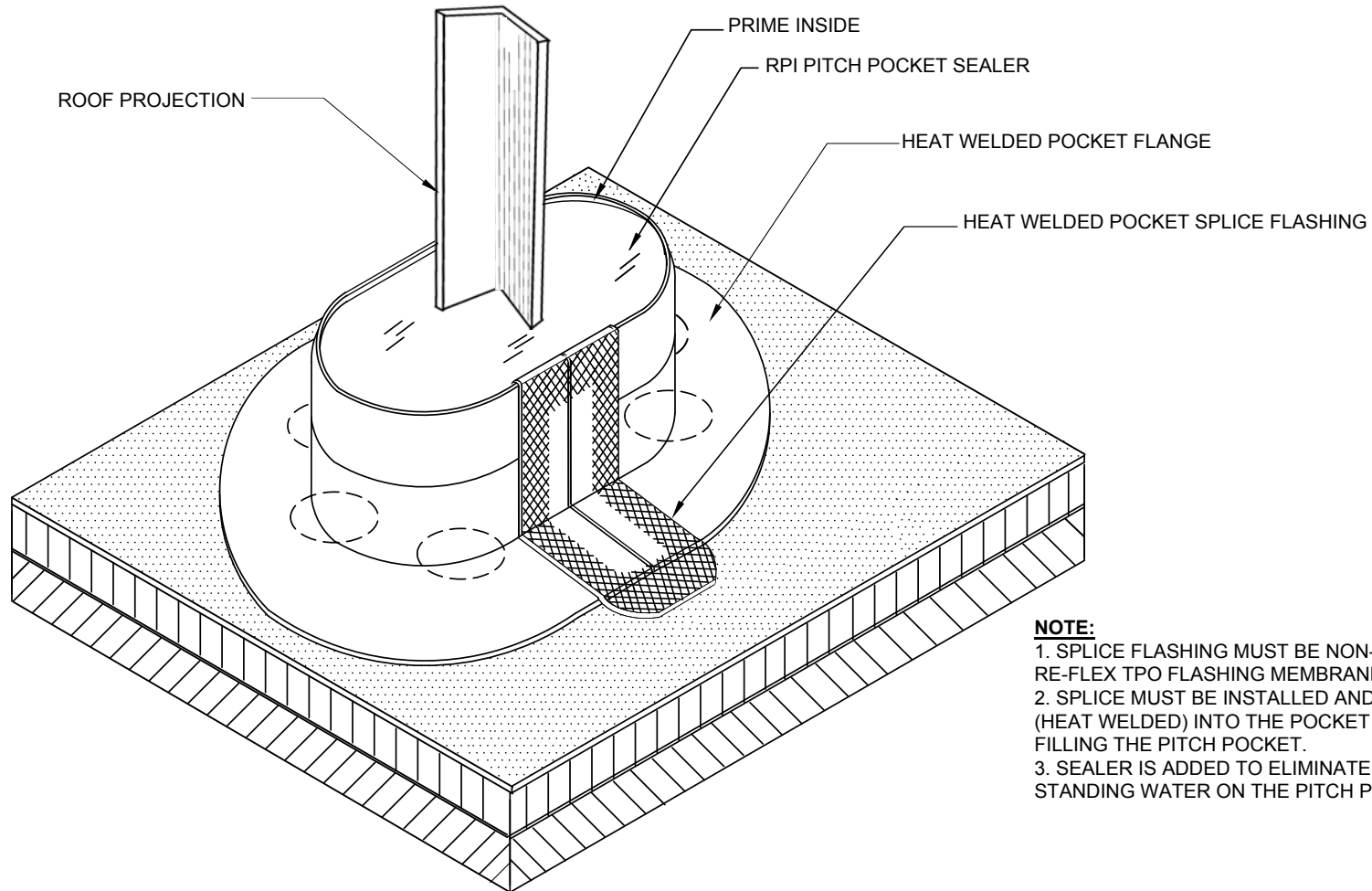

NOTE:

1. SPLICE FLASHING MUST BE NON-REINFORCED RE-FLEX TPO FLASHING MEMBRANE.
2. SPLICE MUST BE INSTALLED AND EXTEND (HEAT WELDED) INTO THE POCKET PRIOR TO FILLING THE PITCH POCKET.
3. SEALER IS ADDED TO ELIMINATE ANY STANDING WATER ON THE PITCH POCKET.

**POURABLE PITCH POCKET
WITH SPLICE DETAIL**

ACCEPTABLE WITH RE-FLEX TPO FULLY ADHERED AND MECHANICALLY ATTACHED SYSTEMS

PROJECT:

SCALE

NOT TO SCALE

Revision Date: 5-10-2015

#337



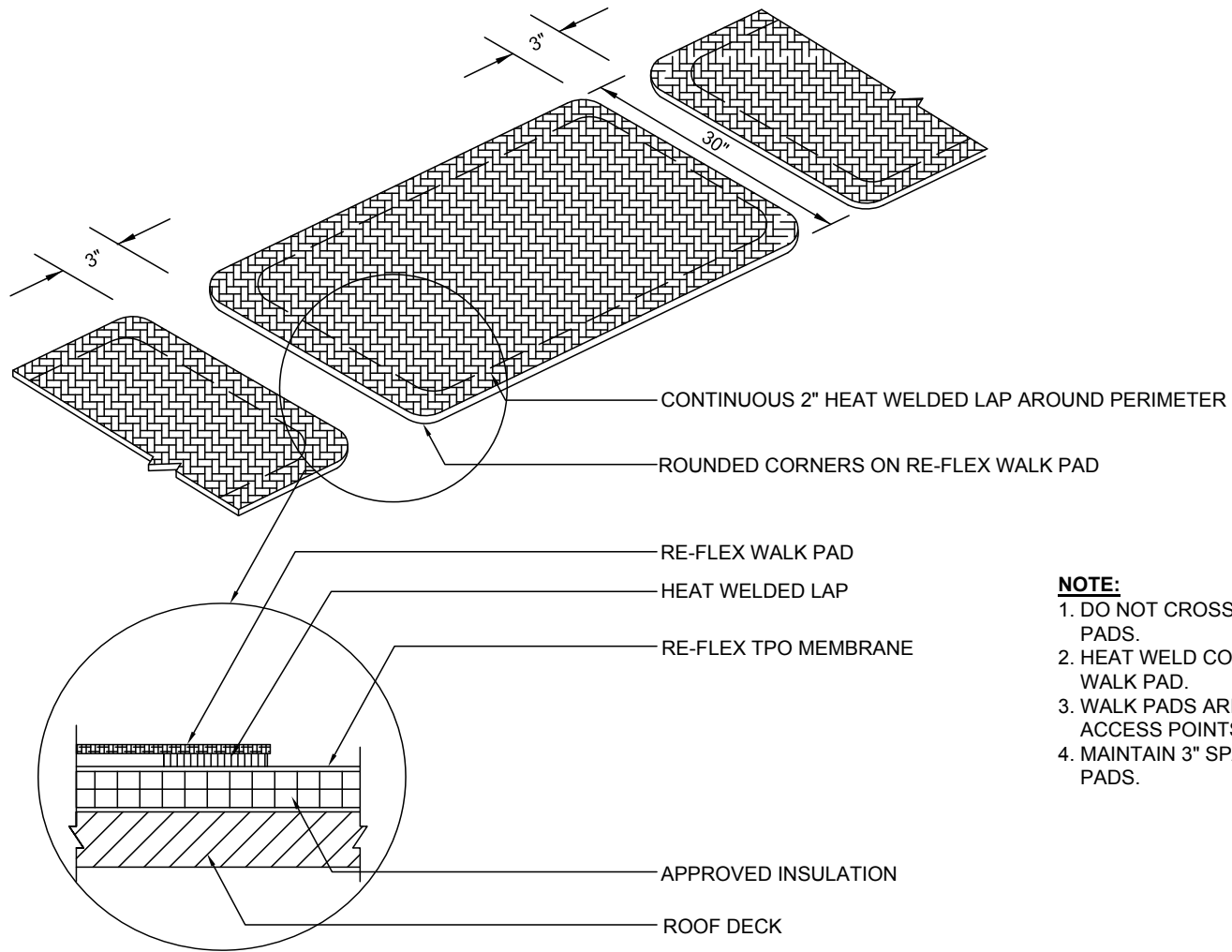

NOTE:

1. DO NOT CROSS FIELD SEAMS WITH WALK PADS.
2. HEAT WELD COMPLETE PERIMETER OF WALK PAD.
3. WALK PADS ARE REQUIRED AT ALL ROOF ACCESS POINTS.
4. MAINTAIN 3" SPACING BETWEEN WALK PADS.

HEAT WELDED WALK PAD DETAIL

ACCEPTABLE WITH RE-FLEX TPO
MECHANICALLY ATTACHED SYSTEMS

PROJECT:

SCALE

NOT TO SCALE

Revision Date: 5-10-2015

#338

